

CUNNINGHAM PARK

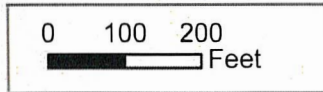
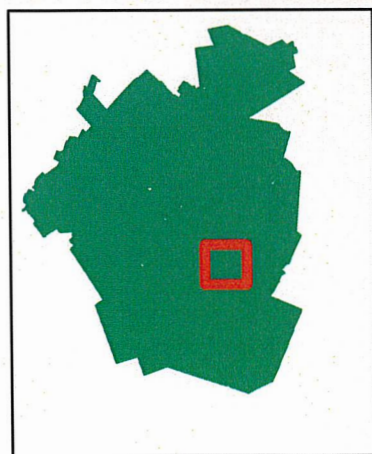

**LEGEND**

Existing Sidewalk —

Proposed Sidewalk —

**LOCATION MAP-**

LULLABY LN SE- Tapawingo to Harmony &  
 HARMONY DR SE- Tapawingo to dead end

Robinson Trust Projects July 8, 2024

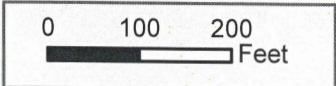
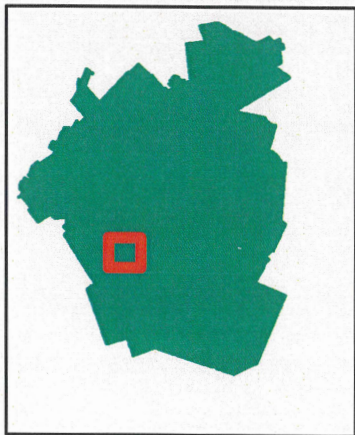
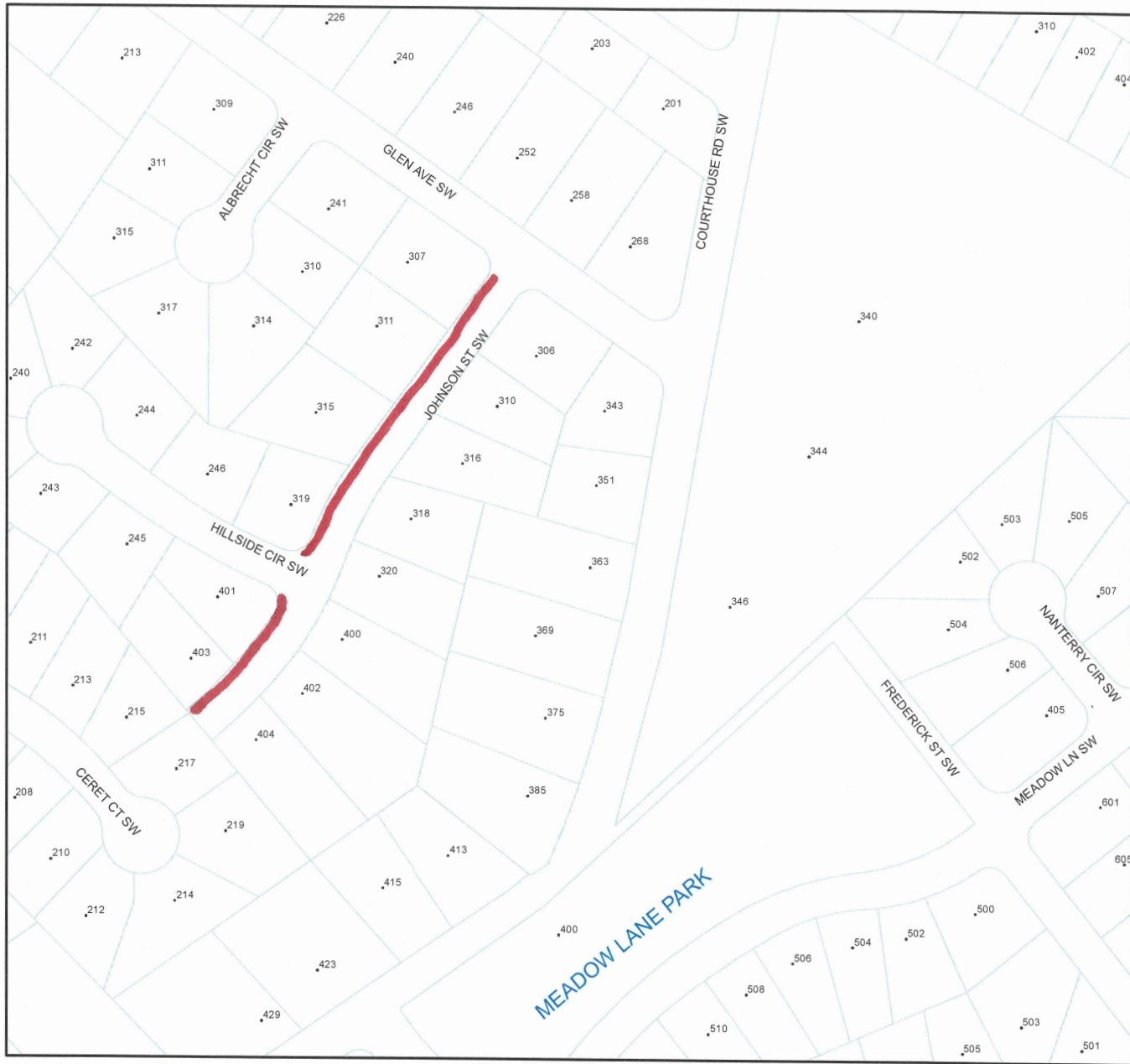

LEGEND

Recommended Project 

LOCATION MAP-

JOHNSON ST SW- Glen Ave to End

Robinson Trust Projects February 26, 2024