

Attachment 5:  
Amended Plat  
Showing Proposed  
Improvements

LOT 16  
A=11,020 S.F  
ZONE: RS-10

LOT 17

N48°18'21"W ~ 95.00'

LOT 15

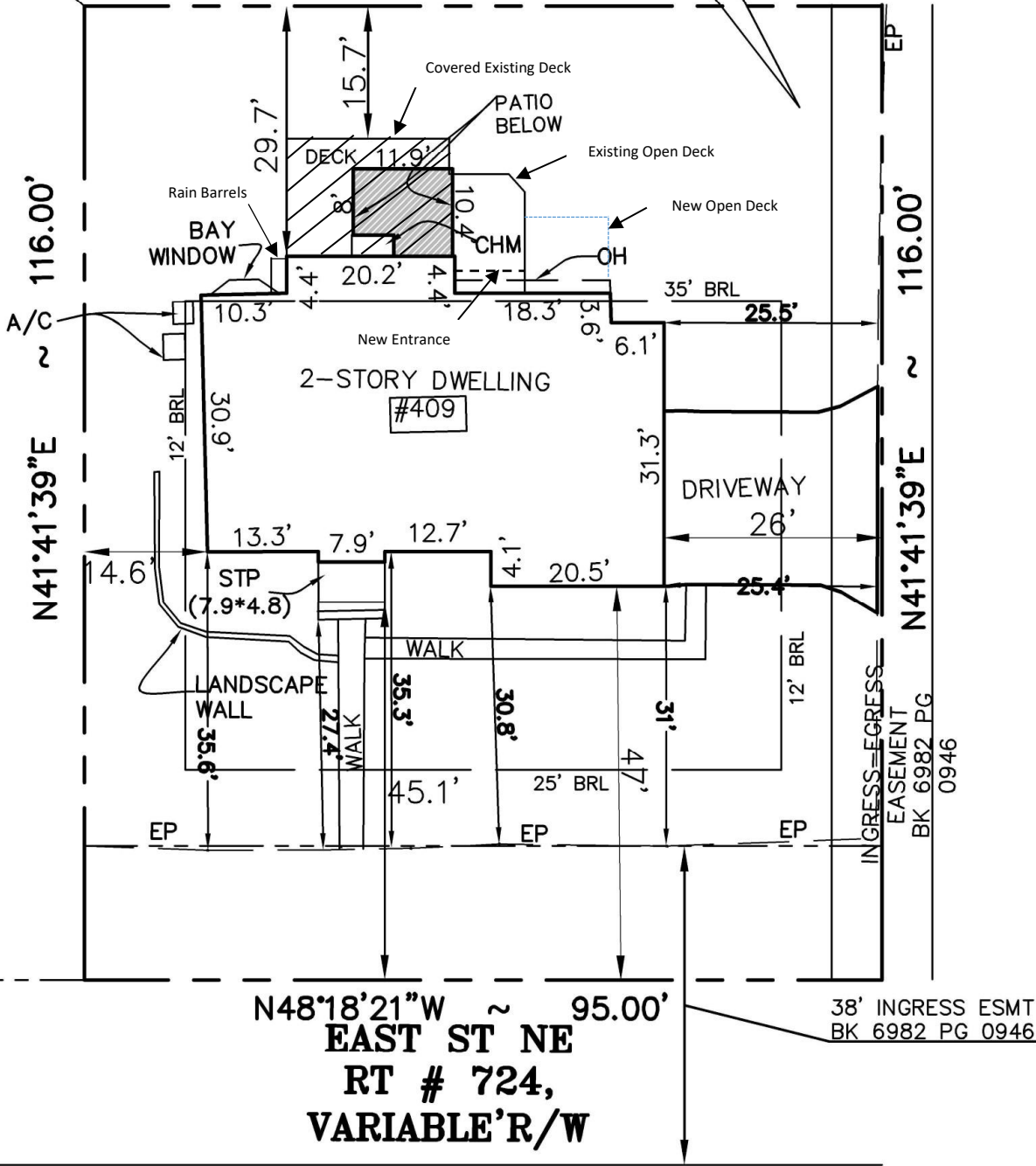

LEGEND

	PATIO BELOW
A/C	AIR CONDITIONING UNIT
OH	OVERHANG
STP	STOOP
CHM	CHIMNEY
EP	EDGE OF PAVEMENT

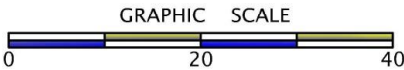

HOUSE LOCATION PLAT  
ON  
EAST CREEK  
LT 16  
409 EAST ST NE VIENNA  
HUNTERMILL DISTRICT  
TOWN OF VIENNA

I HEREBY CERTIFY THAT THE LOCATIONS OF ALL  
EXISTING IMPROVEMENTS HAVE BEEN CAREFULLY  
ESTABLISHED BY A CURRENT FIELD SURVEY AND  
UNLESS SHOWN, THERE ARE NO VISIBLE  
ENCROACHMENTS.

THIS PLAT IS SUBJECT TO RESTRICTIONS OF  
RECORD.

A TITLE REPORT WAS NOT FURNISHED.

NO CORNER MARKERS SET.



PREPARED BY:

**AMA** ENGINEERS, LLC  
CIVIL ENGINEERS. LAND SURVEYORS. PLANNERS

3930 Pender Drive, Suite 310  
Fairfax Virginia 22030  
TEL: 703-273-0300  
info@amaengineers.com