



9 EXISTING TENNIS BUBBLE TO BE REPLACED
(FACING EAST FROM ADJACENT EXISTING POOL HOUSE)



8 EXISTING TENNIS BUBBLE ENTRY ON SOUTH SIDE.
FENCE AND WALKWAY TO BE REMOVED.
(VIEW FACING EAST)



7 EXISTING UTILITIES AND BUBBLE TO BE IMPROVED/REPLACED
(VIEW FACING SOUTH FROM DRIVING RANGE)



6 EXISTING TENNIS BUBBLE TO BE REPLACED
(VIEW OF WEST SIDE AND CONNECTION TO POOL AREA)



5 SOUTHEAST CORNER OF EXISTING TENNIS BUBBLE TO BE REPLACED AND PROPOSED WALKWAY
(VIEW FACING EAST)



4 EXISTING TENNIS BUBBLE TO BE IMPROVED
(VIEW OF EAST SIDE)



3 EXISTING PERSPECTIVE
(FACING SOUTHEAST)



2 EXISTING PERSPECTIVE
(FACING SOUTH)



1 EXISTING PERSPECTIVE
(FACING NORTHEAST)

INDOOR TENNIS FACILITY

WESTWOOD COUNTRY CLUB
800 MAPLE AVE EAST
VIENNA, VA 22180

STRUCTURAL
LINTON ENGINEERING
46090 LAKE CENTER PLAZA, SUITE 309
POTOMAC FALLS, VA 20165
571-323-0320

MECHANICAL ELECTRICAL PLUMBING
BUILT ENVIRONMENT ENGINEERS
5130 WILSON BLVD., 2ND FLOOR
ARLINGTON, VA 22205
703-888-0649

FOOD SERVICE
DRAFTING & DESIGN, LLC
5670 LONG MEADOW ROAD
MIDDLETOWN, VA 22045
410-346-7538

CIVIL
CHRISTOPHER CONSULTANTS
9900 MAIN STREET, SUITE 400
FAIRFAX, VA 22031
703-275-6800

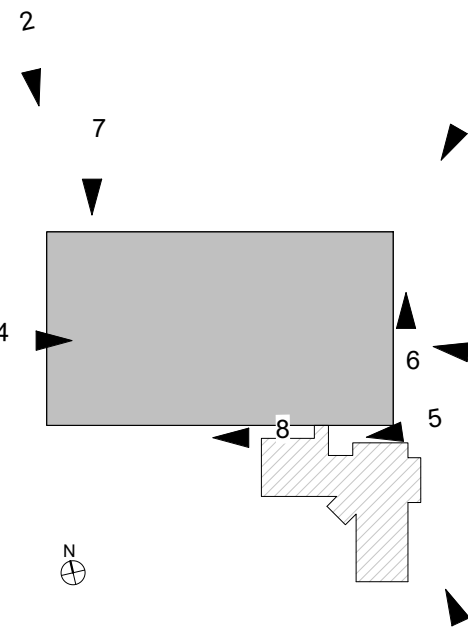

PROJECT # 20536

DATE: 05/26/2021 ISSUE: BAR SUBMISSION

DRAWN: AF CHECKED: BF

SCALE: AS INDICATED

SHEET TITLE:
EXISTING CONDITIONS

© MTFA 2021 ALL RIGHTS RESERVED

SHEET #