

1
C-2

EXISTING EQUIPMENT PLAN
SCALE: 3/8" = 1' (22X34)
SCALE: 3/16" = 1' (11X17)

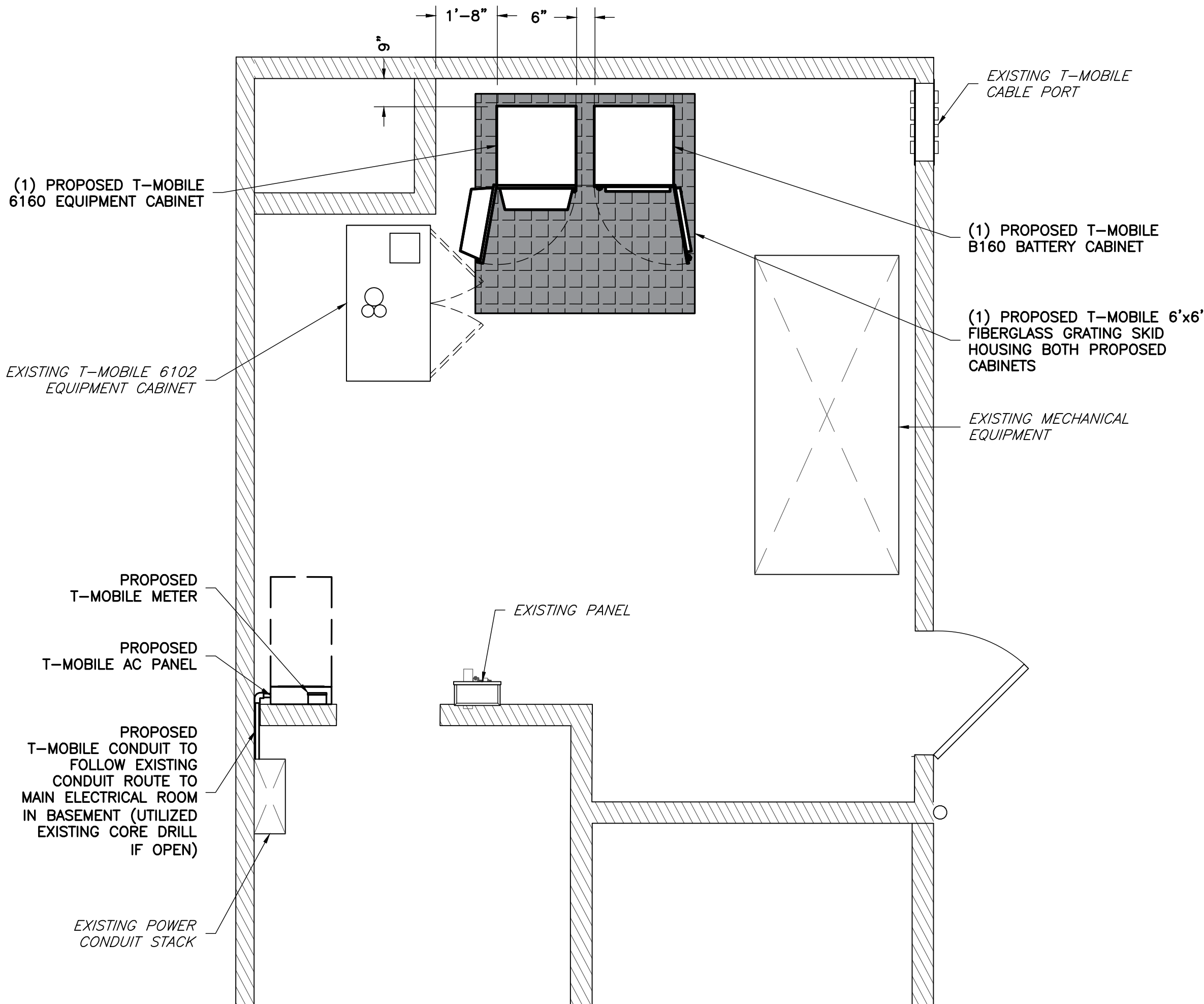
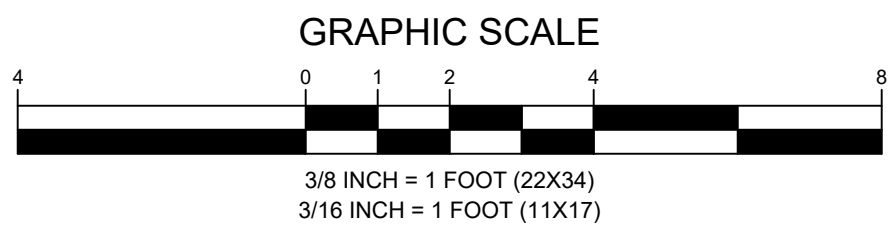

2
C-2

PROPOSED EQUIPMENT PLAN
SCALE: 3/8" = 1' (22X34)
SCALE: 3/16" = 1' (11X17)

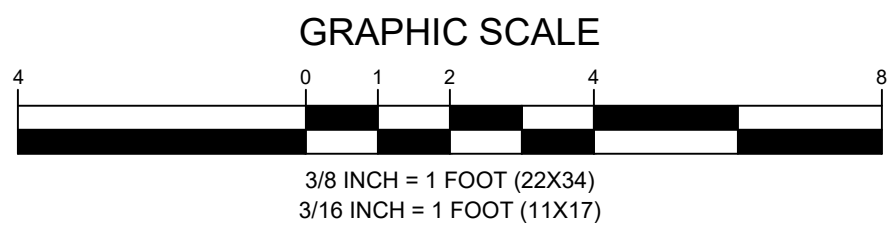

NOTE: EXISTING 6102 CABINET MAY BE RELOCATED BACKWARDS TO PROVIDE ADEQUATE DOOR CLEARANCES.

NOTE: ALL EXISTING COAX CABLES AND TMAS ARE TO BE REMOVED.

APPLICANT

T-Mobile
T-MOBILE NORTHEAST LLC

12050 BALTIMORE AVENUE
BELTSVILLE, MD 20705
OFFICE: (240) 264-8600
FAX: (240) 264-8610

ENGINEER

NB+C
TOTALLY COMMITTED.

NB+C ENGINEERING SERVICES, LLC.
6095 MARSHALEE DRIVE, SUITE 300
ELK RIDGE, MD 21075
(410) 712-7092

SITE INFORMATION

7WAC050A
WHITE OAK TOWER
301 MAPLE AVENUE WEST
VIENNA, VA 22180
TOWN OF VIENNA

DESIGN RECORD

REVISIONS

REV	DATE	DESCRIPTION	BY
0	05/13/21	FINAL CDs	AMM

PROFESSIONAL STAMP

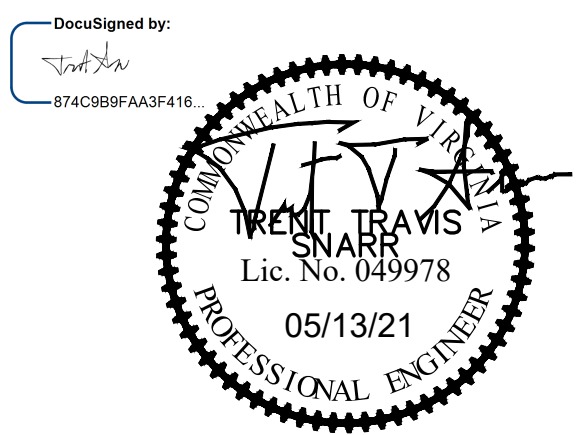

ENGINEER

TRENT TRAVIS SNARR, P.E.
VIRGINIA PROFESSIONAL ENGINEER
LICENSE #049978

SHEET TITLE

**EQUIPMENT
PLANS**

SHEET NUMBER

C-2