

## PLEASE REFERENCE INSTALL INSTRUCTIONS &amp; WIRING DIAGRAMS

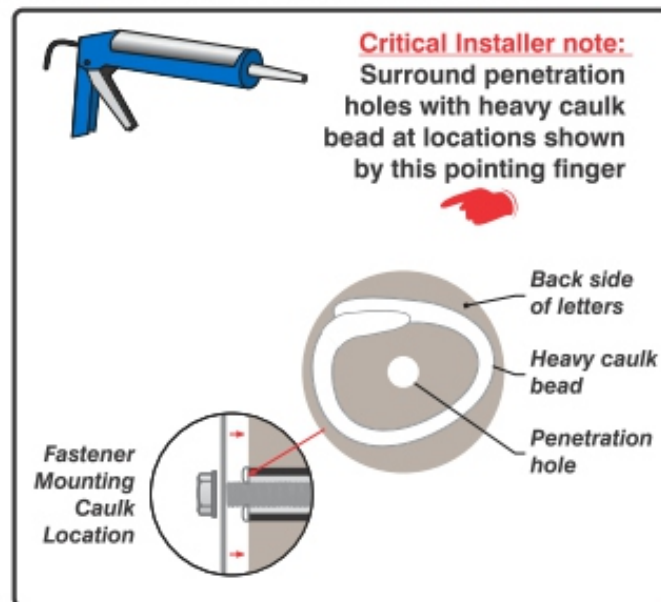
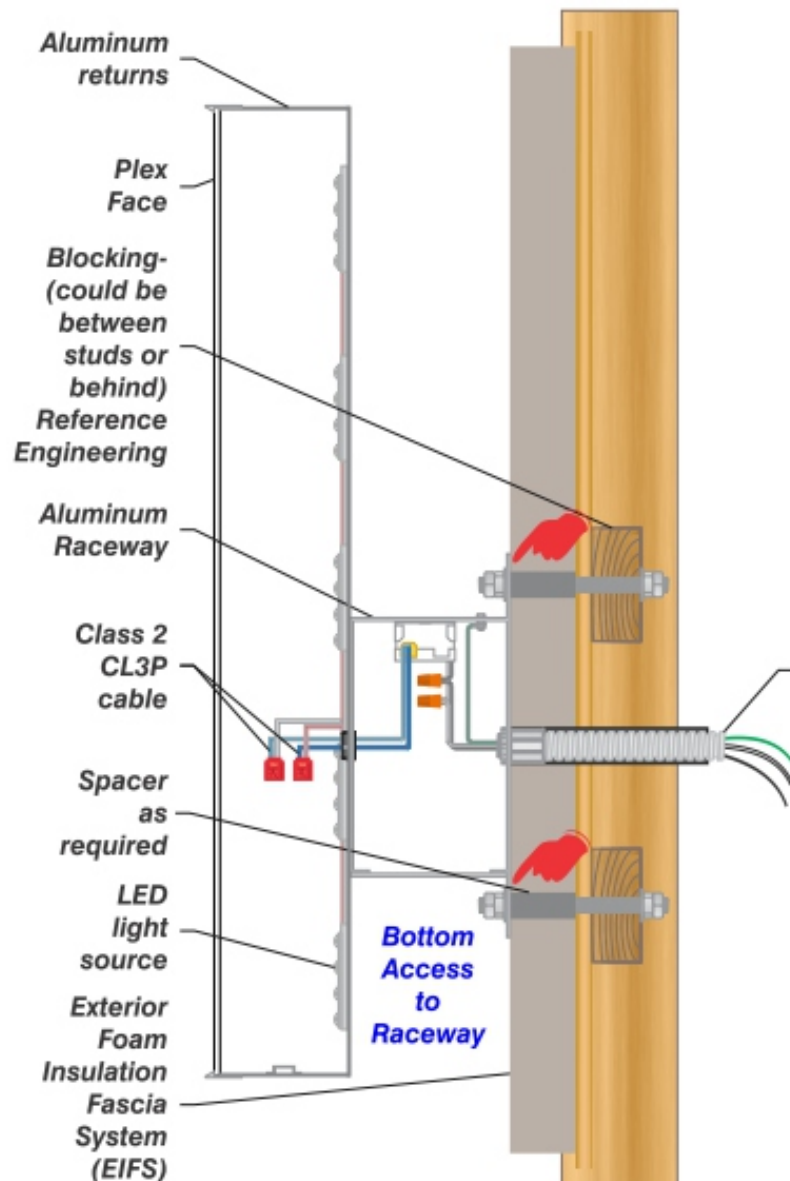
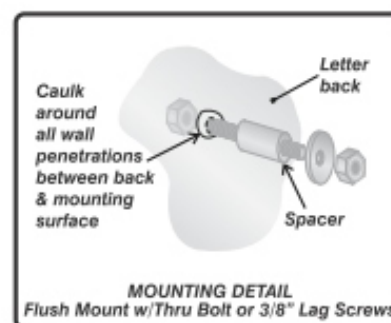

3M Scotchlock 557 & 558  
Connector UL listed - CSA certified  
Insulation Displacement Connector

**INSTALLER NOTE****Provide as required:**

- Silicone Sealant
- Mounting fasteners for site specific wall construction
- Mounting materials required to mount power supply to wall behind display

INST-0006 08/08/2019

**Channel Letter Install Diagram****Typical Mounting & Wiring Detail**

Wall Type: EIFS  
Mounting Type: Raceway

Power Location: Raceway  
Building Rating: Dry/Damp

**persona**  
SIGNS | LIGHTING | IMAGE

DESIGNED BY GUY SPENCER  
700 21st Street Southwest  
PO Box 210  
Watertown, SD 57201-0210  
1.800.843.9888 • www.personasigns.com



This sign is intended to be installed in accordance with the requirements of Article 600 of the National Electric Code and/or other applicable local codes. This includes proper grounding and bonding of the sign.

This is an original document created by Persona Signs, LLC provided specifically to the client for the client's personal use. This document should not be shared, reproduced, disclosed or otherwise used without written permission from Persona Signs, LLC.

Customer Approval (Please Initial):

Approval Date:

**NOTE: INSTALLATION TO BE DETERMINED BY IN-FIELD WALL CONDITIONS**

**PLEASE REFERENCE INSTALL INSTRUCTIONS & WIRING DIAGRAMS**

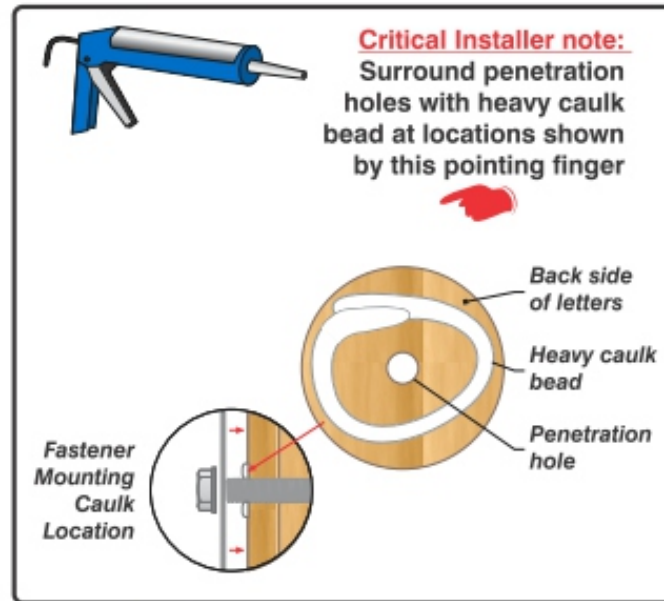
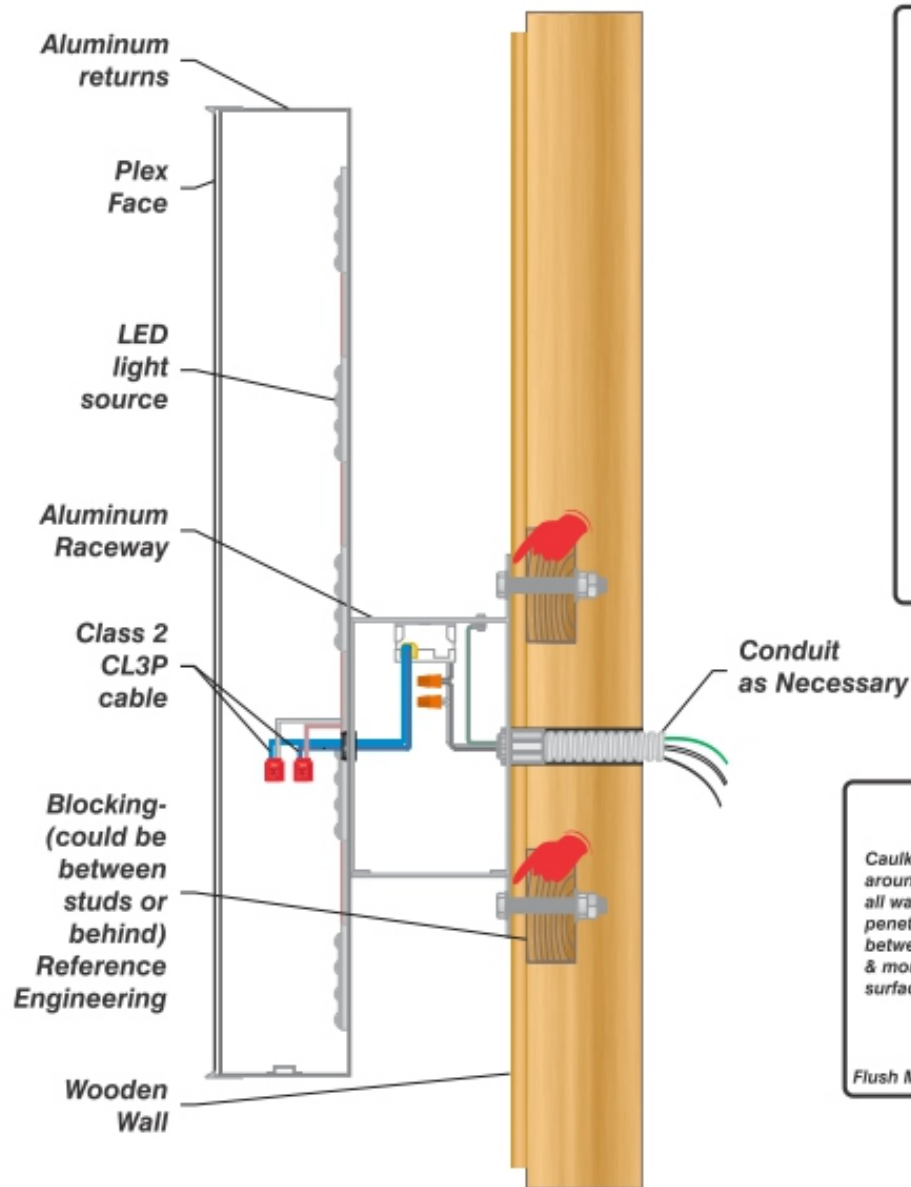

3M Scotchlock 557 & 558  
Connector UL listed - CSA certified  
Insulation Displacement Connector

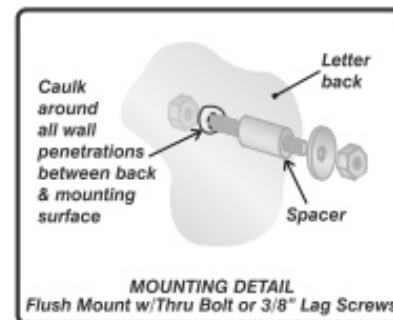

**INSTALLER NOTE**

**Provide as required:**

- Silicone Sealant
- Mounting fasteners for site specific wall construction
- Mounting materials required to mount power supply to wall behind display

INST-0006 08/08/2019

**Channel Letter Install Diagram**

**Typical Mounting & Wiring Detail**

Wall Type: **Wooden Wall**  
Mounting Type: **Raceway**

Power Location: **Raceway**  
Building Rating: **Dry/Damp**

**persona**  
SIGNS | LIGHTING | IMAGE

DESIGNED BY: SDH SPONCHAWY  
700 21st Street Southwest  
PO Box 210  
Watertown, SD 57201-0210  
1.800.843.9888 • www.personasigns.com

**persona**  
SIGNS | LIGHTING | IMAGE

Persona Signs, LLC  
700 21st Street Southwest  
PO Box 210  
Watertown, SD 57201-0210  
1.800.843.9888 • www.personasigns.com

Customer: **DUNKIN'**  
Location: **VIENNA, VA**  
File Name: **484830 - R7 - VIENNA, VA**

Project No.: **484830**  
Request No.: **70143**  
Prepared By: **AL**  
Date: **2/3/25**  
Revision: **7**



This sign is intended to be installed in accordance with the requirements of Article 600 of the National Electric Code and/or other applicable local codes. This includes proper grounding and bonding of the sign.

This is an original document created by Persona Signs, LLC provided specifically to the client for the client's personal use. This document should not be shared, reproduced, disclosed or otherwise used without written permission from Persona Signs, LLC.

Customer Approval (Please Initial):

Approval Date:

NOTE: INSTALLATION TO BE DETERMINED BY IN-FIELD WALL CONDITIONS

PLEASE REFERENCE INSTALL INSTRUCTIONS & WIRING DIAGRAMS

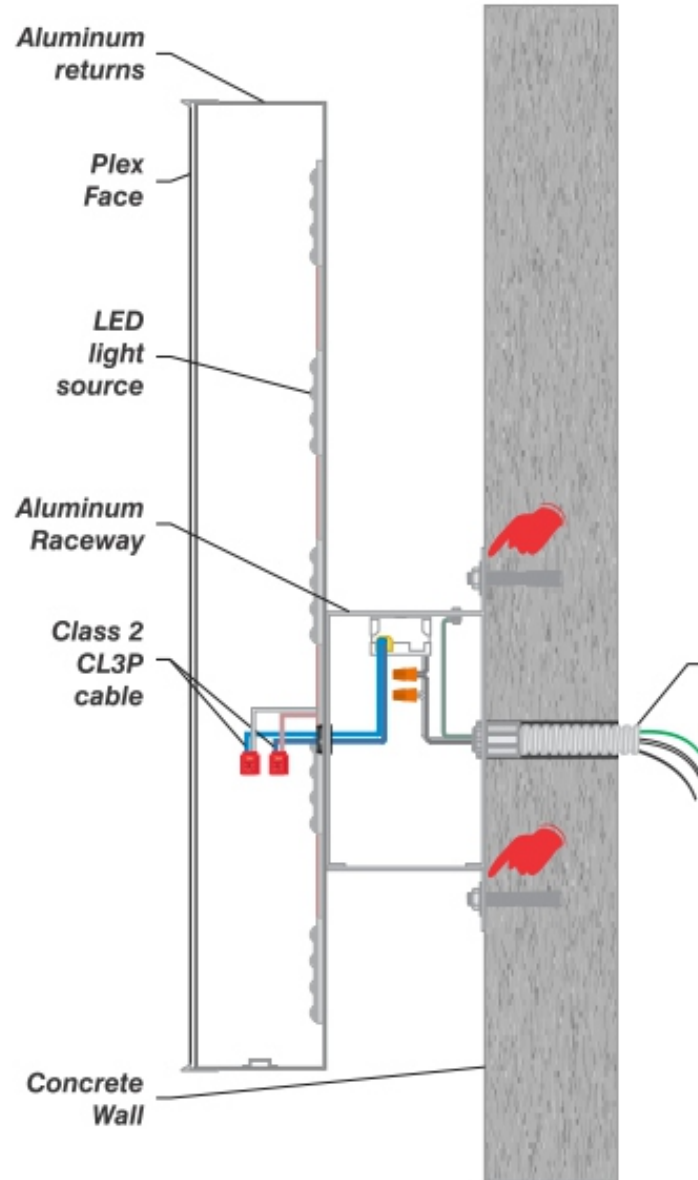

Conduit as Necessary

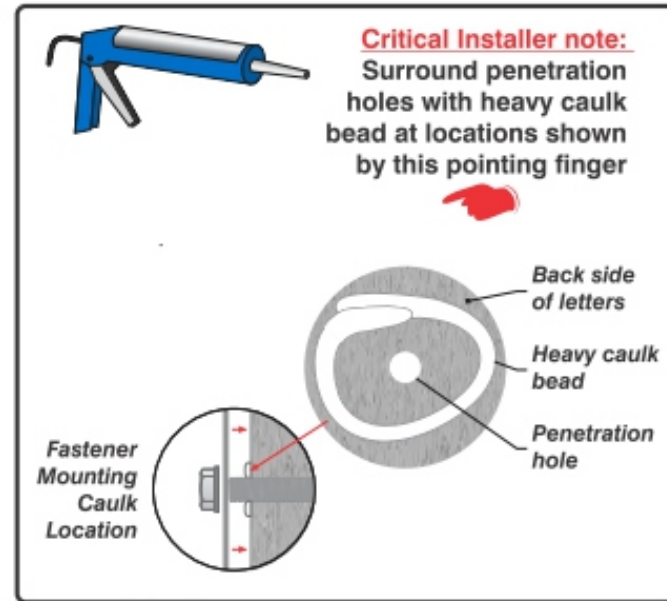

3M Scotchlock 557 & 558  
Connector UL listed - CSA certified  
Insulation Displacement Connector

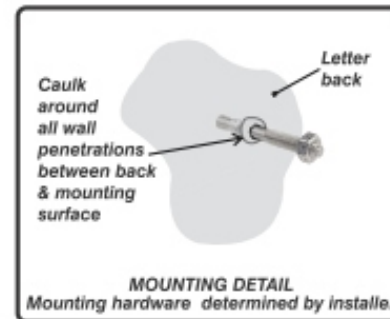

**INSTALLER NOTE**

**Provide as required:**

- Silicone Sealant
- Mounting fasteners for site specific wall construction
- Mounting materials required to mount power supply to wall behind display

INST-0006 08/08/2019

## Channel Letter Install Diagram

**Typical Mounting & Wiring Detail**

Wall Type: **Concrete Wall**  
Mounting Type: **Raceway**

Power Location: **Raceway**  
Building Rating: **Dry/Damp**

**persona**  
SIGNS | LIGHTING | IMAGE

DESIGNED BY SIGN SPECIALTY  
700 21st Street Southwest  
PO Box 210  
Watertown, SD 57201-0210  
1.800.843.9888 • www.personasigns.com

**persona**  
SIGNS | LIGHTING | IMAGE

Persona Signs, LLC  
700 21st Street Southwest  
PO Box 210  
Watertown, SD 57201-0210  
1.800.843.9888 • www.personasigns.com

Customer: **DUNKIN'**  
Location: **VIENNA, VA**  
File Name: **484830 - R7 - VIENNA, VA**

Project No.: **484830**  
Request No.: **70143**  
Prepared By: **AL**  
Date: **2/3/25**  
Revision: **7**

This sign is intended to be installed in accordance with the requirements of Article 600 of the National Electric Code and/or other applicable local codes. This includes proper grounding and bonding of the sign.  
  
This is an original document created by Persona Signs, LLC provided specifically to the client for the client's personal use. This document should not be shared, reproduced, disclosed or otherwise used without written permission from Persona Signs, LLC.

Customer Approval (Please Initial):  
  
Approval Date: