

Landscape Architecture, P.C.

6416 Grosvedale Drive, Suite 100-A  
Alexandria, Virginia 22310  
Tel: 703.719.6500 Fax: 703.719.6503  
Email: frontdesk@studio39.com

VIENNA MARKET  
VIENNA, VIRGINIA

NVR, INC. & NORTHFIELD DEVELOPMENT

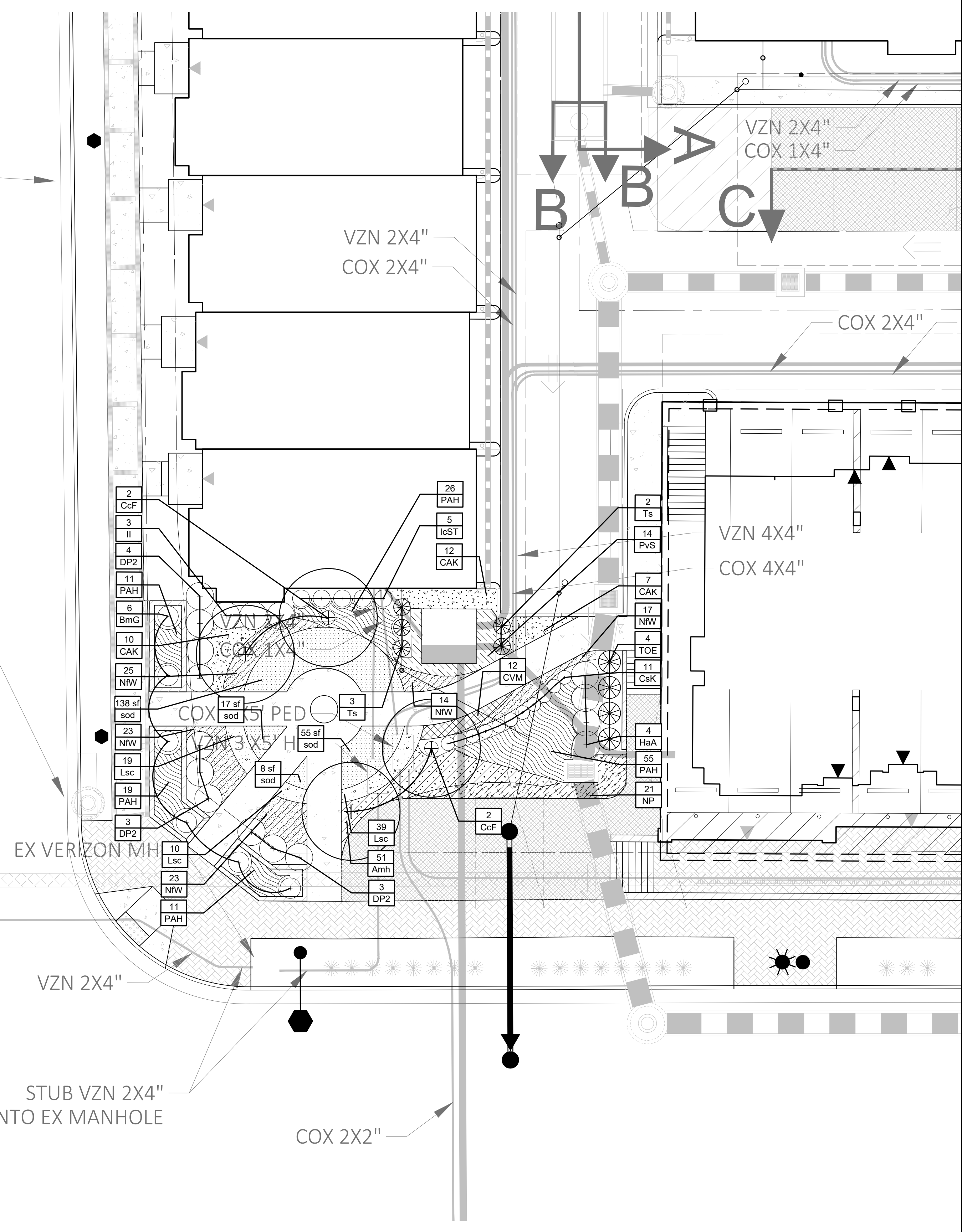
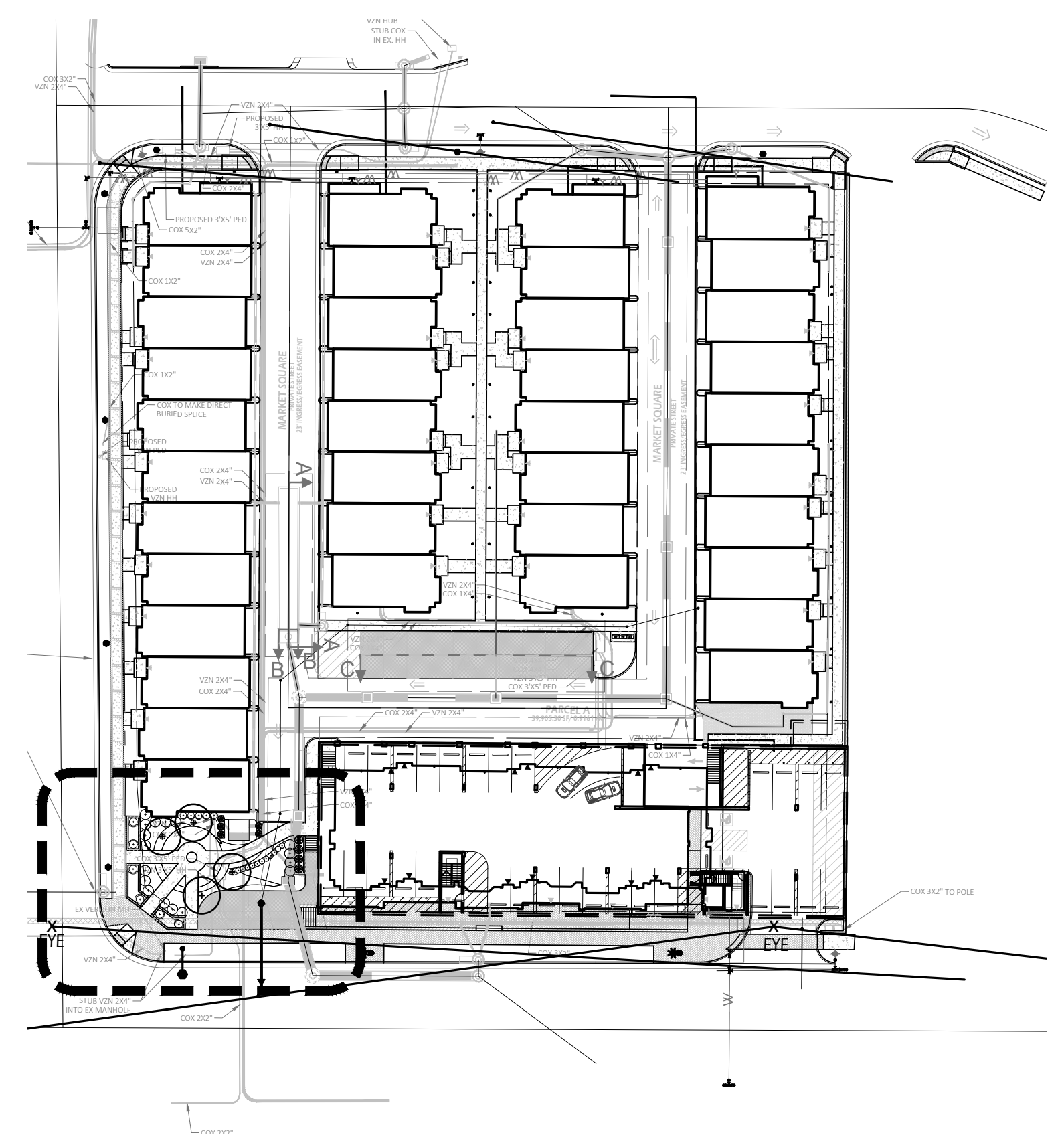

PLANT SCHEDULE CORNER PARK								
TREES	QTY	BOTANICAL NAME	COMMON NAME	HEIGHT	CALIPER	SPREAD	REMARKS	
Ts	5	Thuja occidentalis 'Smaragd'	Emerald Green Arborvitae	6'-8'		3'-4'	full specimen, healthy, vigorous, well-rooted and established	
EVERGREEN TREES	QTY	BOTANICAL NAME	COMMON NAME	HEIGHT	CALIPER	SPREAD	REMARKS	
TOE	4	Thuja occidentalis 'Emerald'	Emerald Arborvitae	6'-8'		3 1/2 - 5'	B&B, full to ground with good seasonal flush	
ORNAMENTAL TREES	QTY	BOTANICAL NAME	COMMON NAME	HEIGHT	CALIPER	SPREAD	REMARKS	
CcF	4	Cercis canadensis 'Forest Pansy'	Forest Pansy Redbud	8'-10'	1 1/2" min.		B&B, multi-trunk, 3 trunk minimum, full symmetrical branching	
SHRUBS	QTY	BOTANICAL NAME	COMMON NAME	HEIGHT	SPREAD	SIZE	SPACING	REMARKS
BmG	6	Buxus microphylla 'Green Mountain'	Green Mountain Boxwood	18"-24"	18"-24"	#3 cont.	3' o.c.	healthy vigorous, well-rooted & established in container
CsK	11	Cornus sericea 'Kelsey'	Kelsey Dogwood	18"-24"	18"-24"	#3 cont.	2' o.c.	full specimen, healthy, vigorous, well-rooted and established
DP2	10	Distylium x PIIDIST-II	Blue Cascade Evergreen Distylium	18"-24"	18"-24"	3 gal	4' o.c.	full specimen, healthy, vigorous, well-rooted and established
HaA	4	Hydrangea arborescens 'Annabelle'	Annabelle Smooth Hydrangea	18"-24"	18"-24"	#3 cont.	4' o.c.	healthy, vigorous, well-rooted & established in container
lcST	5	Ilex crenata 'Soft Touch'	Soft Touch Japanese Holly	2'	2'-3'	#3 cont.	2.5' o.c.	full specimen, healthy, vigorous, well-rooted and established
Il	3	Ilex glabra 'Compacta'	Compact Inkberry	36 - 48"	48"-72"	#3 cont.	3' o.c.	full specimen, healthy, vigorous, well-rooted and established
LAWN GRASSES	QTY	BOTANICAL NAME	COMMON NAME	CONT.	COLOR	SPACING	REMARKS	
sod	218 sf	Turf Sod	Drought Tolerant Fescue Blend	Roll				
PERENNIALS, ORNAMENTAL GRASSES AND FERNS	QTY	BOTANICAL NAME	COMMON NAME	CONT.	COLOR	SPACING	REMARKS	
Amh	51	Amsonia hubrichtii	Arkansas Blue-star	#1 cont.	Blue	24" o.c.	full specimen, healthy, vigorous, well-rooted and established	
CAK	29	Calamagrostis x acutiflora 'Karl Foerster'	Feather Reed Grass	#2 cont.		24" o.c.	full specimen, healthy, vigorous, well-rooted and established	
CVM	12	Coreopsis verticillata 'Moonbeam'	Threadleaf Coreopsis	#1 cont.	pale yellow	18" o.c.	full specimen, healthy, vigorous, well-rooted and established	
Lsc	68	Liriope spicata	Creeping Lily Turf	1 qt.		12" o.c.	full specimen, healthy, vigorous, well-rooted and established	
NP	21	Nassella tenuissima 'Pony Tails'	Mexican Feathergrass	#1 cont.		24" o.c.	full specimen, healthy, vigorous, well-rooted and established	
NW	102	Nepeta x faassenii 'Walkers Low'	Walkers Low Catmint	#1 cont.	blue	16" o.c.	full specimen, healthy, vigorous, well-rooted and established	
PvS	14	Panicum virgatum 'Shenendoah'	Burgundy Switch Grass	#3 cont.		24" o.c.	full specimen, healthy, vigorous, well-rooted and established	
PAH	122	Pennisetum alopecuroides 'Hamel'	Hamel Dwarf Fountain Grass	#2 cont.		18" o.c.	full specimen, healthy, vigorous, well-rooted and established	

THIS DOCUMENT AND THE IDEAS AND DESIGN INCORPORATED HEREIN ARE THE PROPERTY OF STUDIO 39 LANDSCAPE ARCHITECTURE, P.C. AND SHALL REMAIN THE PROPERTY OF STUDIO 39 LANDSCAPE ARCHITECTURE, P.C. UNLESS OTHERWISE SPECIFIED BY THE ARCHITECTURE CONTRACT.

REVISIONS:

CORNER PARK LANDSCAPE PLAN

DESIGN: JB  
DRAWN: JB  
CHECKED: DD

SCALE: 1" = 10' - 0"

PROJECT NO: 19014

DATE: 07.23.19

L6.01

CD

P:\2019\19014 vienna market\6.0 cad files\cd - nvr.incl.6.01 CORNER PARK LANDSCAPE PLAN.dwg

NOT RELEASED FOR CONSTRUCTION

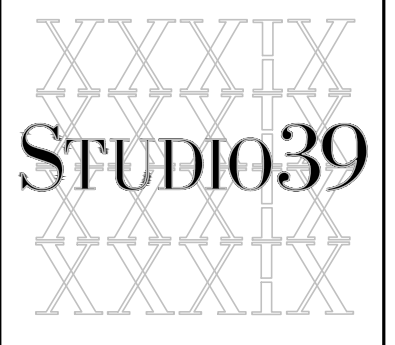

Landscape Architecture, P.C.

6416 Grosvedale Drive, Suite 100-A  
Alexandria, Virginia 22310  
Tel: 703.719.6500 Fax: 703.719.6503  
Email: frontdesk@studio39.com

VIENNA MARKET  
VIENNA, VIRGINIA

NVR, INC. & NORTHFIELD DEVELOPMENT

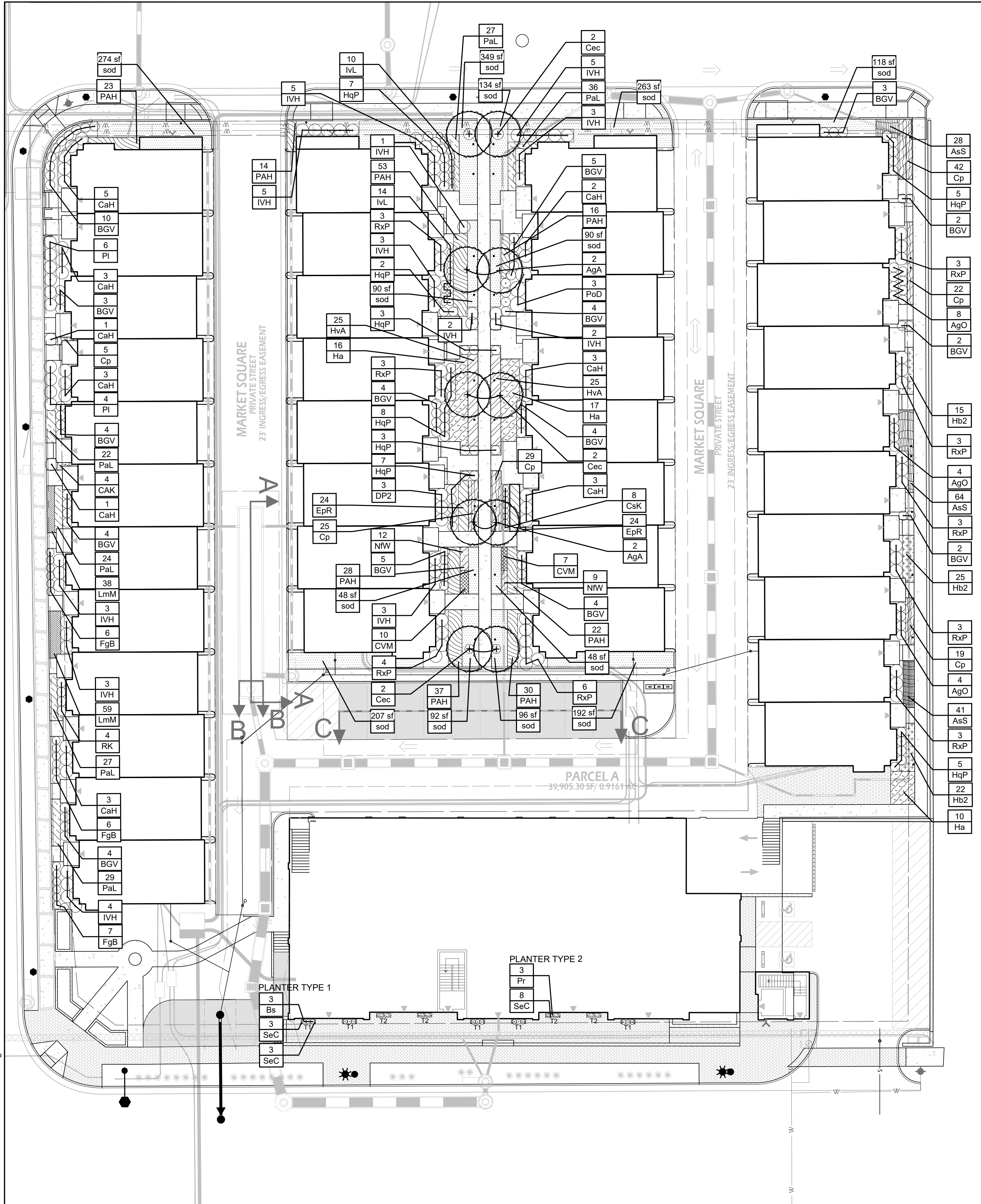

PLANT SCHEDULE TOWNHOMES

ORNAMENTAL TREES	QTY	BOTANICAL NAME	COMMON NAME	HEIGHT	CALIPER	SPREAD	REMARKS	
AgA	4	Amelanchier x grandiflora 'Autumn Brilliance'	'Autumn Brilliance' Serviceberry	8'-10'	1 1/2" min.		B&B, multi-trunk, 3 trunk minimum, full symmetrical branching	
Cec	6	Cercis canadensis	Eastern Redbud	8'-10'	1 1/2" min.		B&B, multi-trunk, 3 trunk minimum, full symmetrical branching	
SHRUBS	QTY	BOTANICAL NAME	COMMON NAME	HEIGHT	SPREAD	SIZE	SPACING	REMARKS
AgO	16	Abelia x grandiflora 'Rose Creek'	Rose Creek Abelia	12"-15"	18"-24"	#2 cont.	3' o.c.	healthy vigorous, well-rooted & established in container
BGV	60	Buxus 'Green Velvet'	Green Velvet Boxwood	18"-24"	18"-24"	#3 cont.	3' o.c.	healthy vigorous, well-rooted & established in container
CaH	24	Clethra alnifolia 'Hummingbird'	Summersweet	18"-24"	18"-24"	#3 cont.	4' o.c.	healthy, vigorous, well-rooted & established
CsK	8	Cornus sericea 'Kelsey'	Kelsey Dogwood	18"-24"	18"-24"	#3 cont.	2' o.c.	full specimen, healthy, vigorous, well-rooted and established
DP2	3	Distylium x PIIIDIST-II	Blue Cascade Evergreen Distylium	18"-24"	18"-24"	3 gal	4' o.c.	full specimen, healthy, vigorous, well-rooted and established
FgB	19	Fothergilla gardenii 'Blue Mist'	Blue Mist Fothergilla	15"-18"	18"-24"	#3 cont.	2' o.c.	healthy, vigorous, well-rooted & established in container
HqP	40	Hydrangea quercifolia 'Pee Wee'	Oakleaf Hydrangea	18"-24"	18"-24"	#3 cont.	3' o.c.	healthy, vigorous, well-rooted & established in container
IVH	39	Itea virginica 'Henry's Garnet'	Henry's Garnet Sweetspire	18"-24"	18"-24"	#3 cont.	4' o.c.	healthy vigorous, well-rooted & established in container
IVL	24	Itea virginica 'Little Henry'	Virginia Sweetspire	18"-24"	18"-24"	#3 cont.	2' o.c.	healthy vigorous, well-rooted & established in container
PoD	3	Physocarpus opulifolius 'Diablo'	Diablo Ninebark	24"-36"	18"-24"	#3 cont.	5' o.c.	healthy vigorous, well-rooted & established in container
PI	10	Physocarpus opulifolius 'Little Devil' TM	Dwarf Ninebark	-	-	-	-	healthy vigorous, well-rooted & established in container
RxP	31	Rhododendron x 'P.J.M.'	P.J.M. Rhododendron	24"-30"	18"-24"	#3 cont.	4' o.c.	healthy, vigorous, well-rooted & established in container
RK	4	Rosa x 'Knockout'	Rose	18"-24"	18"-24"	#3 cont.	3' o.c.	healthy, vigorous, well-rooted & established in container
GROUNDCOVERS	QTY	BOTANICAL NAME	COMMON NAME	CONT.	COLOR	SPACING	REMARKS	
LmM	97	Liriope muscari 'Monroe White'	Monroe White Liriope	1 qt.		12" o.c.	full specimen, healthy, vigorous, well-rooted and established	
LAWN GRASSES	QTY	BOTANICAL NAME	COMMON NAME	CONT.	COLOR	SPACING	REMARKS	
sod	2,001 sf	Turf Sod	Drought Tolerant Fescue Blend	Roll				
PERENNIALS, ORNAMENTAL GRASSES AND FERNS	QTY	BOTANICAL NAME	COMMON NAME	CONT.	COLOR	SPACING	REMARKS	
AsS	133	Astilbe simplicifolia 'Sprite'	Sprite Astilbe	#1 cont.	pink	14" o.c.	full specimen, healthy, vigorous, well-rooted and established	
CAK	3	Calamagrostis x acutiflora 'Karl Foerster'	Feather Reed Grass	#2 cont.		24" o.c.	full specimen, healthy, vigorous, well-rooted and established	
Cp	142	Carex pensylvanica	Pennsylvania Sedge	#1 cont.		18" o.c.	full specimen, healthy, vigorous, well-rooted and established	
CVM	17	Coreopsis verticillata 'Moonbeam'	Threadleaf Coreopsis	#1 cont.	pale yellow	18" o.c.	full specimen, healthy, vigorous, well-rooted and established	
EpR	48	Echinacea purpurea 'Ruby Glow'	Purple Coneflower	#1 cont.		18" o.c.	full specimen, healthy, vigorous, well-rooted and established	
HvA	50	Heuchera villosa 'Autumn Bride'	Autumn Bride Heuchera	#1 cont.		24" o.c.	full specimen, healthy, vigorous, well-rooted and established	
Hb2	62	Heuchera x 'Blackberry Ice' TM	Dolce Blackberry Ice Heuchera	1 qt.	Purple	18" o.c.	full specimen, healthy, vigorous, well-rooted and established	
Ha	43	Hosta x 'Sum and Substance'	Plantain Lily	2 gal	Chartreuse	36" o.c.	full specimen, healthy, vigorous, well-rooted and established	
NW	21	Nepeta x faassenii 'Walkers Low'	Walkers Low Catmint	#1 cont.	blue	16" o.c.	full specimen, healthy, vigorous, well-rooted and established	
PAH	223	Pennisetum alopecuroides 'Hameln'	Hameln Dwarf Fountain Grass	#2 cont.		18" o.c.	full specimen, healthy, vigorous, well-rooted and established	
PaL	165	Pennisetum alopecuroides 'Little Bunny'	Little Bunny Fountain Grass	#1 cont.		15" o.c.	full specimen, healthy, vigorous, well-rooted and established	

THIS DOCUMENT AND THE IDEAS AND DESIGN INCORPORATED HEREIN ARE THE PROPERTY OF STUDIO 39 LANDSCAPE ARCHITECTURE, P.C. AND SHALL REMAIN THE PROPERTY OF STUDIO 39 LANDSCAPE ARCHITECTURE, P.C. UNLESS OTHERWISE SPECIFICALLY STATED BY LANDSCAPE ARCHITECTURE, P.C.

REVISIONS:

TOWN HOME LANDSCAPE PLAN

DESIGN: JB  
DRAWN: JB  
CHECKED: DD

SCALE: 1" = 20' 0"

PROJECT NO: 19014

DATE: 07.23.19

L6.02

CD

P:\2019\19014\_Vienna Market\6.0 Land\6.02 Town Home Landscape Plan.dwg

NOT RELEASED FOR CONSTRUCTION

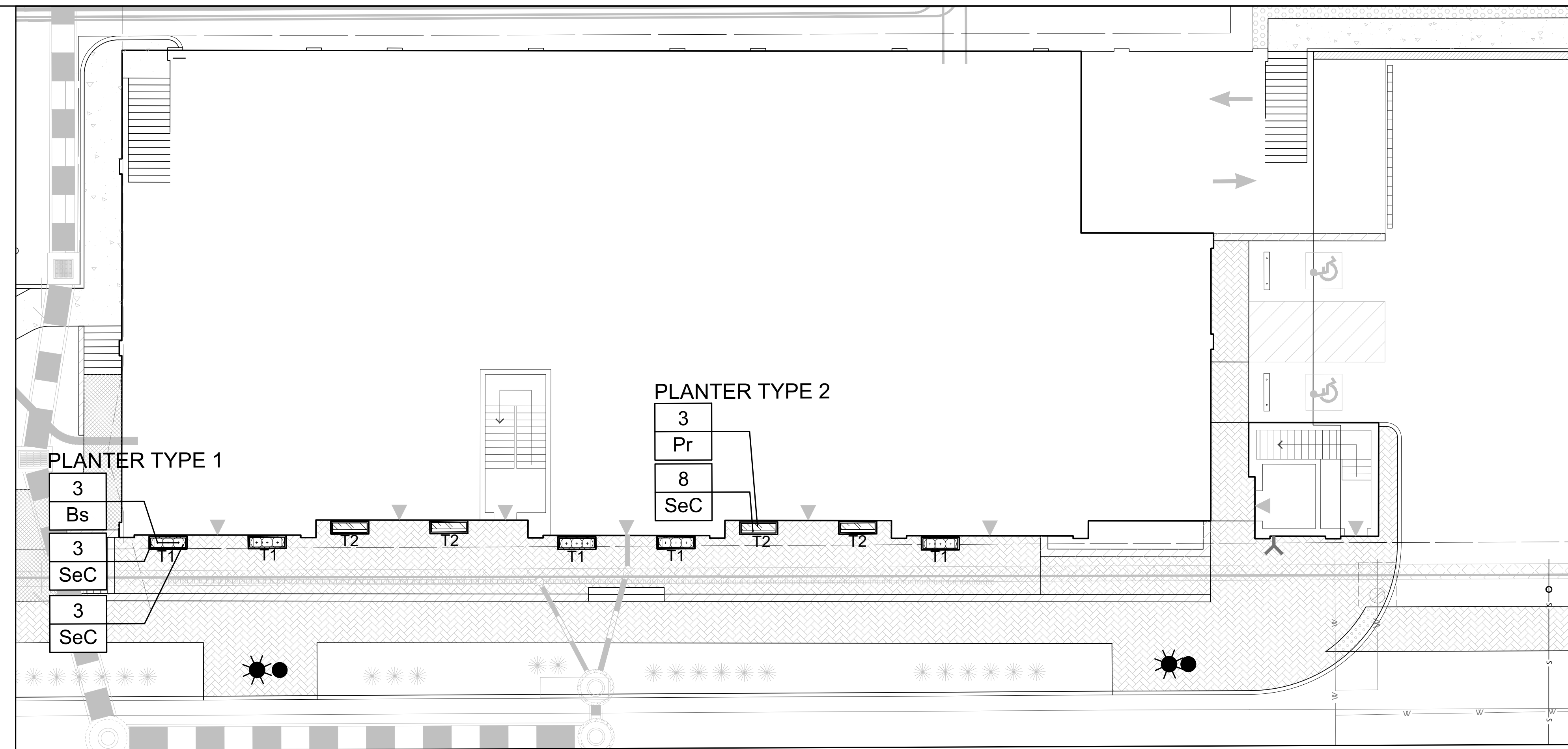

PLANT SCHEDULE RETAIL PLANTERS								
<b>SHRUBS</b>								
Bs	15	<i>Buxus sempervirens</i> 'Suffruticosa'	True Dwarf Boxwood	1'-2"	1'-2"	#2 cont.	1.5'	full specimen, healthy, vigorous, well-rooted and established
<b>PERENNIALS, ORNAMENTAL GRASSES AND FERNS</b>								
SeC	38	Seasonal Color	Seasonal Color	1 qt.	Varies	6" o.c.		full specimen, healthy, vigorous, well-rooted and established
Pr	12	<i>Pennisetum setaceum</i> 'Rubrum'	Purple Fountain Grass	2 gal	Purple	16" o.c.		full specimen, healthy, vigorous, well-rooted and established

1 RETAIL PLANTERS PLAN AND SCHEDULE PLAN  
L6.03 Scale: 1:10



MODEL: ORE HIGH RECTANGLE 1110  
 SIZE: 60" L x 20" W x 24" H  
 FINISH: POWDER COAT FINISH COLOR BLACK  
 QUANTITY: SEE PLAN  
 COMPANY: ORE  
 132 PIERPONT AVE.  
 SALT LAKE CITY, UT 84101  
 CONTACT: ORE DESIGN  
 CALVIN SMOTHERS  
 P: 801.836.0499  
 csmothers@ore.design.com  
 FINISH: 1)INSTALL PER MANUFACTURER'S RECOMMENDATIONS  
 2) CONTRACTOR TO VERIFY QTY.  
 3)SEE PLANS FOR LOCATION AND QUANTITY

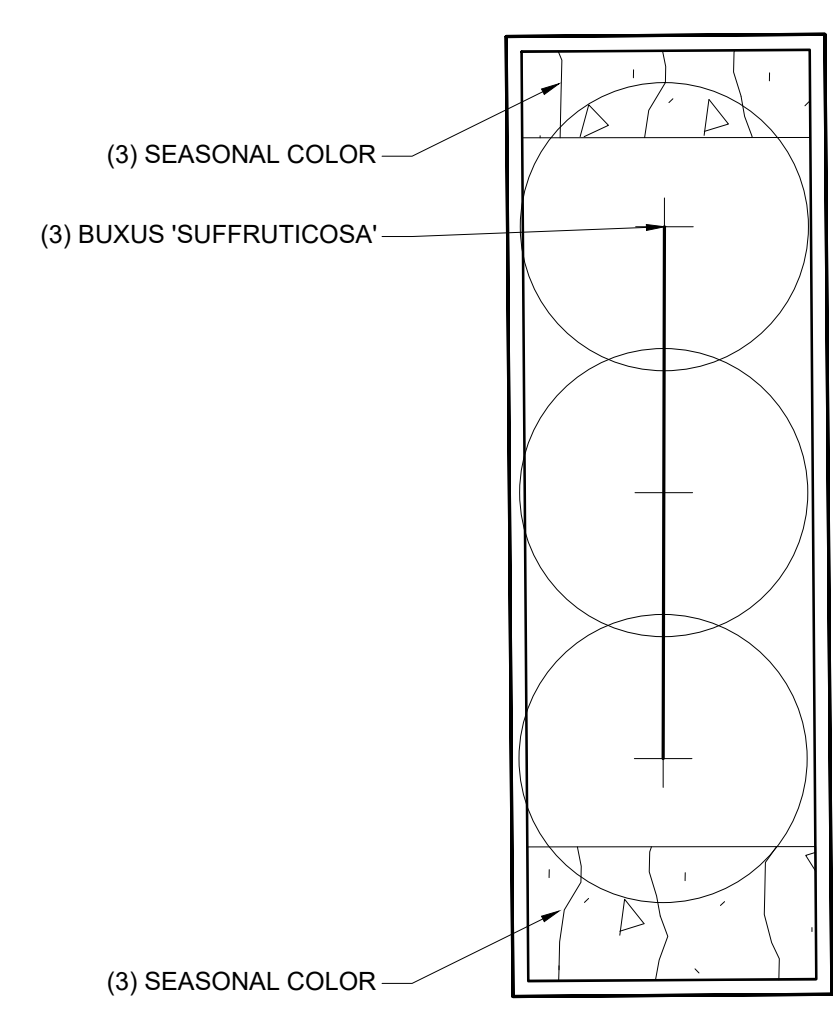

3 PLANTER TYPE 1 PLAN  
L6.03 Scale: 1" = 1'

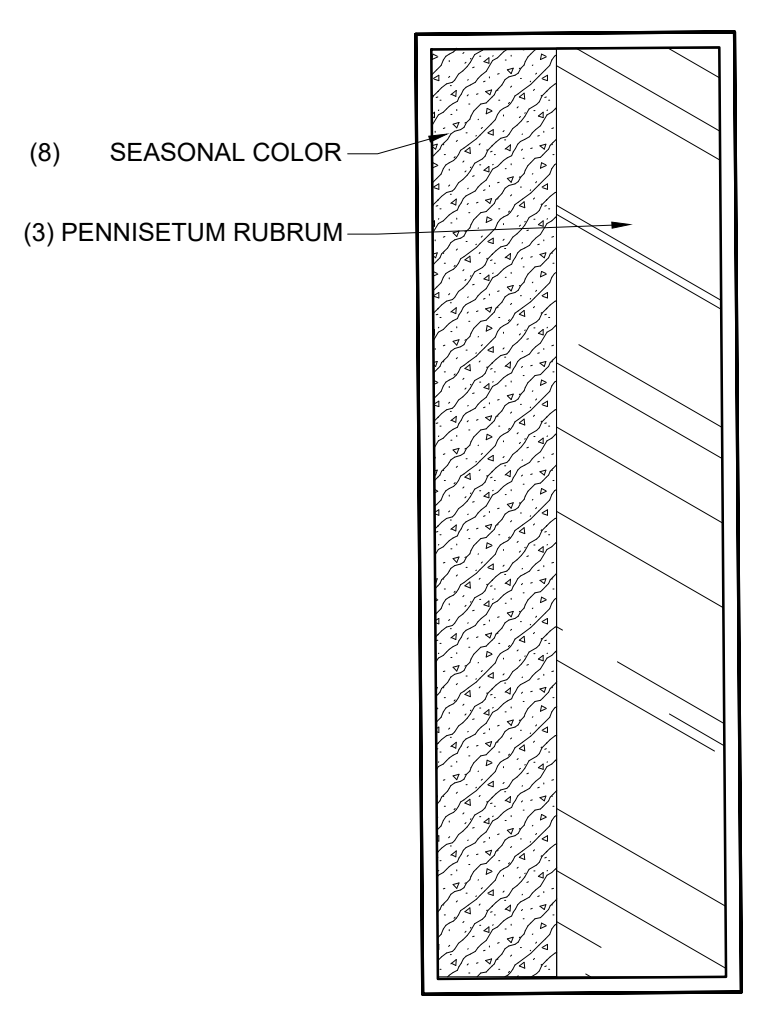

4 PLANTER TYPE 2 PLAN  
L6.03 Scale: 1" = 1'-0"

2 RAISED PLANTER PROD. INFO.  
L6.03 Scale: NTS

THIS DOCUMENT AND THE IDEAS AND DESIGN INCORPORATED HEREIN ARE THE PROPERTY OF PROFESSIONAL SERVICE TO THE PROPERTY OF STUDIO 39 LANDSCAPE ARCHITECTURE, P.C. AND SHALL NOT BE REPRODUCED OR TRANSMITTED IN ANY FORM OR BY ANY MEANS WITHOUT THE WRITTEN PERMISSION OF STUDIO 39 LANDSCAPE ARCHITECTURE, P.C.  
 © STUDIO 39 LANDSCAPE ARCHITECTURE, P.C.

REVISIONS:

RETAIL LANDSCAPE PLAN

DESIGN: JB  
 DRAWN: JB  
 CHECKED: DD  
 NORTH

SCALE: 1" = 20'-0"

0 10 20 40

PROJECT NO: 19014  
 DATE: 07.23.19

L6.03

CD

P:\2019\19014 vienna market\6.0 cad files\cd - nvr\incl\6.03 RETAIL LANDSCAPE PLAN.dwg

NOT RELEASED FOR CONSTRUCTION