

- SYMBOL KEY**
- WASTE RECEPTACLE - SEE SHEET CD6
 - ▭ BENCH (BACKED) - SEE SHEET CD6
 - ▭ BENCH (BACKLESS) - SEE SHEET CD6
 - PLANTERS - SEE SHEET CD6
 - POLE MOUNTED LIGHTS - SEE SHEET CD5
 - ▨ CONCRETE PAVERS - SEE SHEET CD2
 - ▨ PIGMENTED CONCRETE PAVING - SEE SHEET CD2
 - ▨ BRICK PAVING - SEE SHEET CD2
 - ▨ BICYCLE RACKS - SEE SHEET CD6
 - FENCE - SEE SHEET CD3
 - P.A. PLANTING AREAS - SEE SHEET PL1
 - ♿ ACCESSIBLE PARKING - SHEET CD1
 - ▨ STONE DUST PAVING - SEE SHEET CD2
 - ▨ STRUCTURAL SOIL AREAS - SEE SHEET C6 FOR LAYOUT SEE SHEET CD2 FOR DETAIL

GENERAL NOTES:

1. THE PROPERTY SHOWN HEREON IS IDENTIFIED ON FAIRFAX COUNTY TAX ASSESSMENT MAPS 38-2 - (22) - 104 (ZONED C-1A) AND 38-2 - (22) - 129 (ZONED C-1A) AND WERE ACQUIRED BY DEED RECORDED IN DEED BOOK 3168, AT PAGE 37 AND DEED BOOK 12442, AT PAGE 629 ALL RECORDED AMONG THE LAND RECORDS OF FAIRFAX COUNTY, VIRGINIA.
2. ELEVATIONS SHOWN HEREON ARE BASED ON AN ASSUMED VERTICAL DATUM.
3. NORTH MERIDIAN TAKEN FROM RECORDS INFORMATION RECORDED IN DEED BOOK 3168, AT PAGE 37 RECORDED AMONG THE LAND RECORDS OF FAIRFAX COUNTY, VIRGINIA.
4. THE SUBJECT PROPERTY IS LOCATED IN A FLOOD HAZARD ZONE "C" (AREAS OF MINIMAL FLOODING) PER FIRM COMMUNITY - PANEL NUMBER 510053 0001B, EFFECTIVE FEBRUARY 3, 1982.
5. NO WETLANDS DELINEATION AND/OR MAPPING WAS DONE AS PART OF THIS SURVEY.
6. PINEY BRANCH IS CLASSIFIED AS AN INTERMITTENT STREAM, NO RPAs ARE LOCATED ON THE PROPERTY.
7. UNLESS OTHERWISE SHOWN HEREON NO OBSERVABLE EVIDENCE OF CEMETERIES WAS NOTED ON THE SUBJECT PROPERTY.
8. NO ATTEMPT HAS BEEN MADE AS A PART OF THIS SURVEY TO OBTAIN OR SHOW DATA CONCERNING EXISTENCE, SIZE, DEPTH, CONDITION, CAPACITY OR LOCATION OF ANY UTILITIES OR MUNICIPAL/PUBLIC SERVICE FACILITY. FOR INFORMATION REGARDING THESE UTILITIES OR FACILITIES, PLEASE CONTACT THE APPROPRIATE AGENCIES.

LEGEND:

- APP APPLE TREE
- BB BOTTOM OF SLOPE
- BC BUILDING
- BLD BUILDING
- BOL BOLLARD
- BOL1 BOLLARD
- BRK BREAKLINE
- BSH BUSH
- BSMT BASEMENT
- BW BOTTOM OF WALL
- CED CEDAR TREE
- CL CENTERLINE
- CO CLEANOUT
- CON CONCRETE
- DEC DECK
- DT DIRT
- EG EDGE OF GRAVEL
- ELE ELECTRIC MISC.
- ENT ENTRANCE
- EP EDGE OF PAVEMENT
- ETOW EDGE OF TOWER
- FC FACE OF CURB
- FEE FIRST FLOOR ELEVATION
- FL FLOW LINE
- FP FLAG POLE
- GR GRASS
- GRB BRICK SPOT SHOT
- GRC CONCRETE SPOT SHOT
- GRG GRAVEL SPOT SHOT
- GRP PAVEMENT SPOT SHOT
- GS GROUND SPOT SHOT
- GW GUY WIRE
- HC HANDICAPPED RAMP/SIGN
- HOL HOLLY TREE
- INV INVERT
- IPF IRON PIPE FOUND
- LP LIGHT POLE
- MAP MAPLE TREE
- MB MAILBOX
- MH MANHOLE
- WKP UTILITY MARKER POST
- OAK OAK TREE
- OH OVERHANG
- OHE OVERHEAD ELECTRIC
- PED TELEPHONE PEDESTAL
- PIN PINETREE
- PIPE PIPE
- PL PROPERTYLINE
- PP POWER POLE
- RIP RIP-RAP
- RW RETAINING WALL
- SDM STORM DRAIN M.H.
- SAN SEWER
- SMH SEWER MANHOLE
- SN SIGN
- STP STEP
- STR STREAM
- SW SIDEWALK
- TB TOP OF SLOPE
- TL TREE LINE
- TMH TELEPHONE MANHOLE
- TW TOP OF WALL
- VEG VEGETATION
- VLT VAULT
- WDF WOOD FENCE
- WL WATER LINE
- WM WATER METER

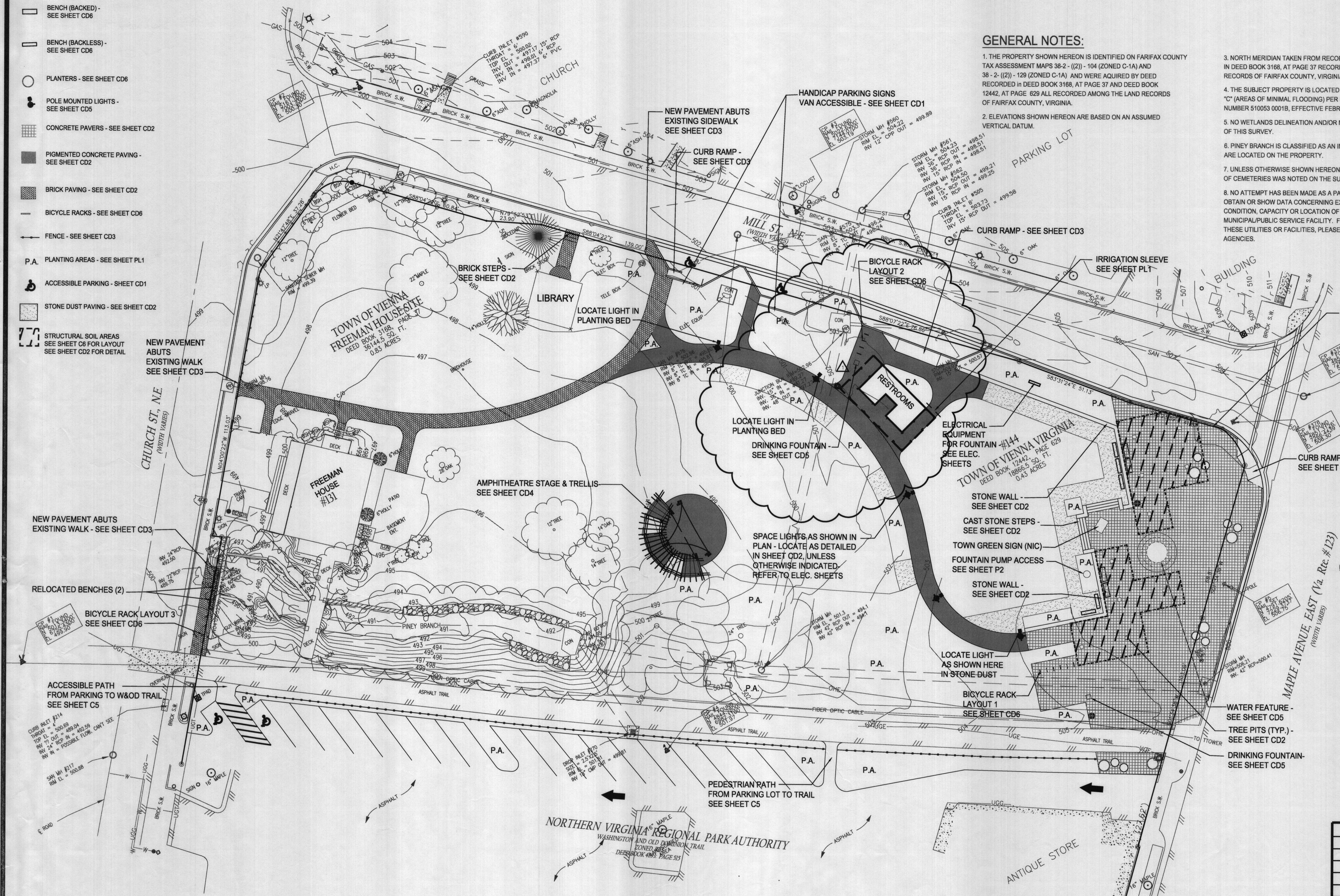

APPROVED
 PLANNING & ZONING DEPT.
 TOWN OF VIENNA, VA.
 By *[Signature]* Z.A.
 Date 8/10/06

WARNING!
 It is Unlawful to perform any construction Above Foundation Corners prior to Approval of Setback. Work completed in violation of this requirement is subject to Demolition. 18-233-B

SETBACK INSPECTION REQUIRED
 8/10/06
 ZONING ADMINISTRATOR
 CHESAPEAKE BAY ORD.
 TOWN OF VIENNA
 N.A.
 APPROVED
 DENIED

ALL DUMPSTERS ARE TO BE PLACED ON PRIVATE PROPERTY

REVISION NO.	DATE	DESCRIPTION
1	04-27-06	Sheet Title & Graphic Clarification

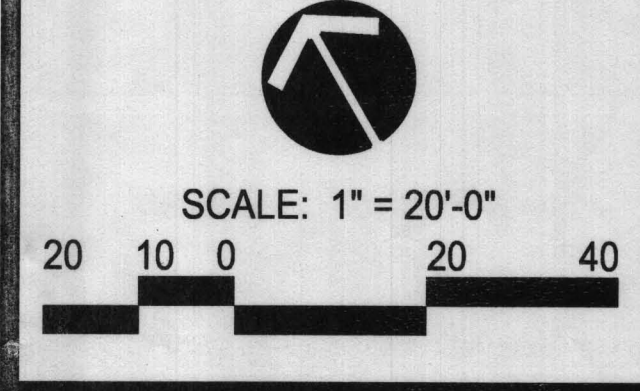

SURVEY	ELECTRICAL	ARCHITECT	LANDSCAPE ARCHITECT	ENGINEER	CONSTRUCTION DOCUMENTS	DESIGNED: EL, VM DRAWN: GM TECH. REVIEW: EL, VM DATE: 03/15/2006	SUB SHEET NO. C1	TITLE OF SHEET SITE PLAN VIENNA TOWN GREEN TOWN OF VIENNA	DRAWING NO. PKG. NO. SHEET 4 OF 26
--------	------------	-----------	---------------------	----------	------------------------	---	--------------------------------	--	---

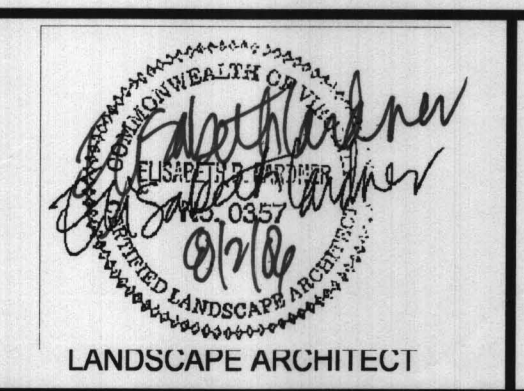

CIVIL ENGINEER:
Wiley & Wilson
 Employee-Owned
 6806 WEST BROAD STREET,
 SUITE 500
 RICHMOND, VIRGINIA 23230-1717
 804-254-7242 ph
 804-254-7257 fax

LANDSCAPE ARCHITECT:
 LARDNER/KLEIN
 LANDSCAPE ARCHITECTS, PC
 814 KING ST., FOURTH FLOOR
 ALEXANDRIA, VA 22314-3039
 703-739-0972ph 1-800-337-1370ph
 703-739-0973fax