

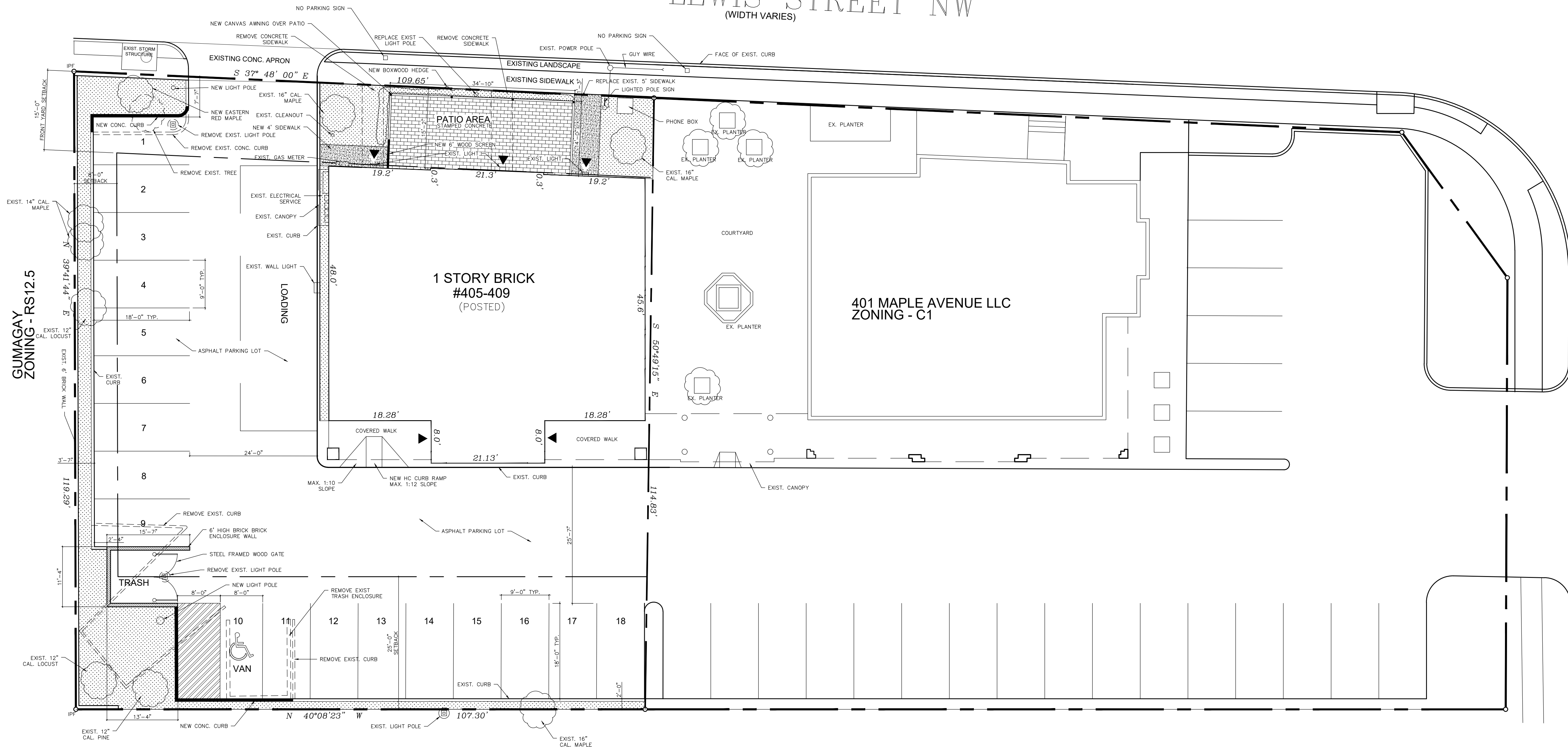

DATE: 2-3-2020
 JOB NUMBER: 2019.14
 SCALE: SHOWN
 DRAWN BY: LB
 CHECK BY: TK
 REVISIONS:

AMPHORA RESTAURANT
 GEORGE BILIDAS
 ZONING - C1

LEWIS STREET NW
 (WIDTH VARIES)



MAPLE AVENUE W

GUMAGAY
 ZONING - RS12.5

401 MAPLE AVENUE LLC
 ZONING - C1

1 STORY BRICK
 #405-409
 (POSTED)

FIRST VIRGINIA BANK, TA BB&T
 ZONING - C1

SITE AREA - 12,693 SF
 LANDSCAPE AREA - 1,302 SF (10.26%)
 BUILDING GROSS FLOOR AREA - 2,922 SF

BUILDING USE GROUP - MERCANTILE "M", ASSEMBLY "A-3"
 BUILDING CONSTRUCTION TYPE - 2B
 HEIGHT OF EXISTING BUILDING - 20'-0"

PARKING SPACES REQUIRED - 1 PER 4 SEATS @ 72 SEATS = 18 SPACES
 PARKING SPACES PROVIDED - 18 SPACES INCLUDING 1 HANDICAP VAN SPACE
 INDOOR SEATING - 72 SEATS

FRONT YARD AREA - 1,640 SF
 FRONT YARD LANDSCAPE AREA - 514 SF (31%)

SITE PLAN
 HAWK & GRIFFIN PUBLIC HOUSE

BILIDAS & CHOLAKIS PROPERTY
 DEED BOOK 6314, PAGE 573
 FAIRFAX COUNTY, VIRGINIA

A1