

## ELEVATION

SCALE - 3/32" = 1'- 0"

Item	Description	Qty	Sign Area	Allowed
B	Wall Sign - Cloud Sign	1	180.00	BELOW
C	Wall Sign - Drive Thru	1	8.80	BELOW
E	Wall Sign - Icon	1	8.27	BELOW
Aggregate Totals			197.07	210.00



5198 North Lake Drive  
Lake City, GA 30260  
404.361.3800  
www.claytonsigns.com

## ELEVATION

DRAWING FILE - CFA - VIENNA, VA SIGNAGE.CDR

ALL ELECTRICAL  
SIGNS ARE  
120 VOLTS  
UNLESS  
OTHERWISE INDICATED

DRAWN BY Ben Holliday  
ACCOUNT REP. Ben Holliday  
DRAWING DATE June 16, 2016  
REVISION DATE May 15, 2020

STORE NUMBER  
**L03582**

### STORE ADDRESS

Chick-fil-A at Vienna, VA  
540 Maple Avenue W  
Vienna, VA 22180

THIS DRAWING IS AN ORIGINAL, UNPUBLISHED DESIGN CREATED BY CLAYTON SIGNS, INC. IT IS NOT TO BE REPRODUCED, CHANGED, OR EXHIBITED TO ANYONE OUTSIDE OF YOUR COMPANY IN WHOLE OR IN PART WITHOUT WRITTEN PERMISSION FROM THE OWNER OF CLAYTON SIGNS, INC. ANY SUCH ACTIONS MAY BE SUBJECT TO LEGAL ACTION IN A COURT OF LAW.

©2018 ALL RIGHTS RESERVED

BUILDING  
ELEVATIONS

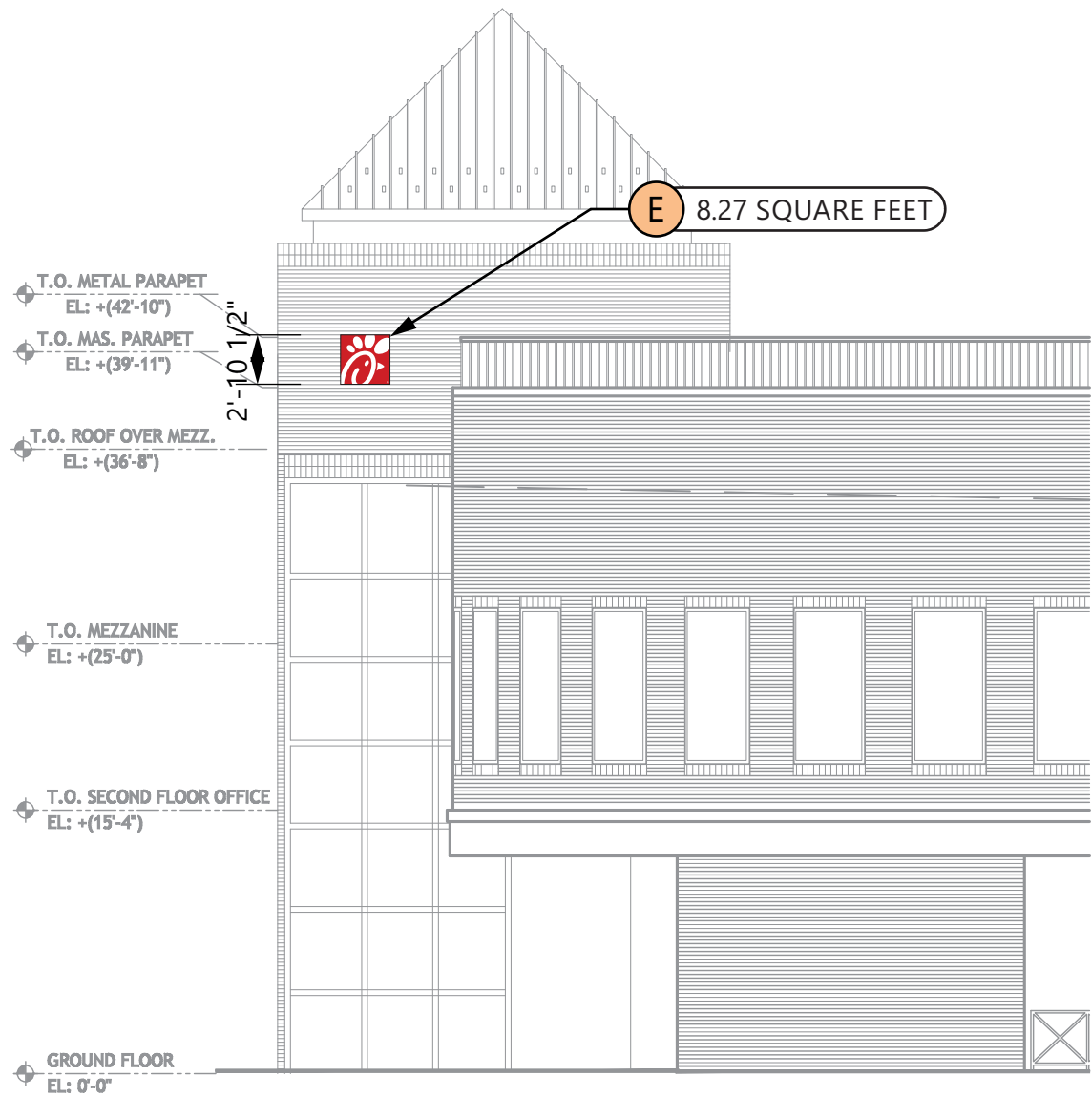

ELEVATION

SCALE - 3/32" = 1'- 0"



ELEVATION

SCALE - 3/32" = 1'- 0"

Item	Description	Qty	Sign Area	Allowed
B	Wall Sign - Cloud Sign	1	180.00	BELOW
C	Wall Sign - Drive Thru	1	8.80	BELOW
E	Wall Sign - Icon	1	8.27	BELOW
F	Wall Sign - Icon	1	8.27	BELOW
Aggregate Totals			205.34	210.00



5198 North Lake Drive  
Lake City, GA 30260  
404.361.3800  
www.claytonsigns.com

ELEVATION

DRAWING FILE - CFA - VIENNA, VA SIGNAGE.CDR

ALL ELECTRICAL  
SIGNS ARE  
120 VOLTS  
UNLESS  
OTHERWISE INDICATED

DRAWN BY Ben Holliday  
ACCOUNT REP. Ben Holliday  
DRAWING DATE June 16, 2016  
REVISION DATE May 15, 2020

STORE NUMBER	STORE ADDRESS
L03582	Chick-fil-A at Vienna, VA 540 Maple Avenue W Vienna, VA 22180

THIS DRAWING IS AN ORIGINAL, UNPUBLISHED DESIGN CREATED BY CLAYTON SIGNS, INC. IT IS NOT TO BE REPRODUCED, CHANGED, OR EXHIBITED TO ANYONE OUTSIDE OF YOUR COMPANY IN WHOLE OR IN PART WITHOUT WRITTEN PERMISSION FROM THE OWNER OF CLAYTON SIGNS, INC. ANY SUCH ACTIONS MAY BE SUBJECT TO LEGAL ACTION IN A COURT OF LAW.  
©2018 ALL RIGHTS RESERVED

BUILDING  
ELEVATIONS

SPECIFICATIONS

CHICK-FIL-A SCRIPT LETTERS  
CABINET IS LED-ILLUMINATED  
WITH TRANSFORMERS REMOTELY  
LOCATED BEHIND THE WALL IN  
UL APPROVED TRANSFORMER BOXES.  
FACES ARE 3/16" ACRYLIC  
RETURNS ARE .063 ALUMINUM  
BACKS ARE .080 ALUMINUM  
ALL RETURNS ARE ARC-WELDED TO  
LETTER BACKS

FACES AND TRIM

WHITE ACRYLIC DECORATED WITH PAINTED  
OPAQUE GREY BACKGROUND TO MATCH  
PANTONE 431C  
RETAINER- 1" GREY TRIM

ALUMINUM RETURNS  
PAINTED TO MATCH  
TAYLOR CLAY PRODUCTS  
301-W WHITE WIRE-CUT BRICK

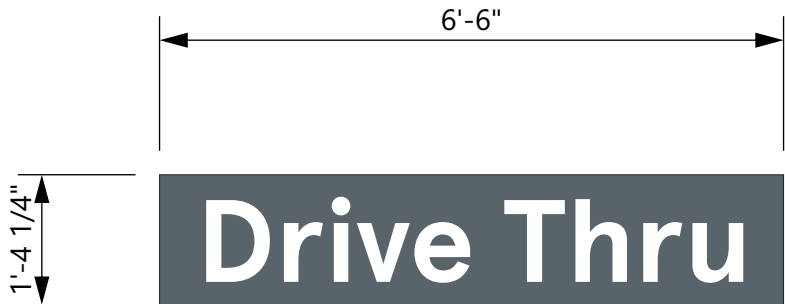

ELEVATION

SCALE - 1/2" = 1'- 0"

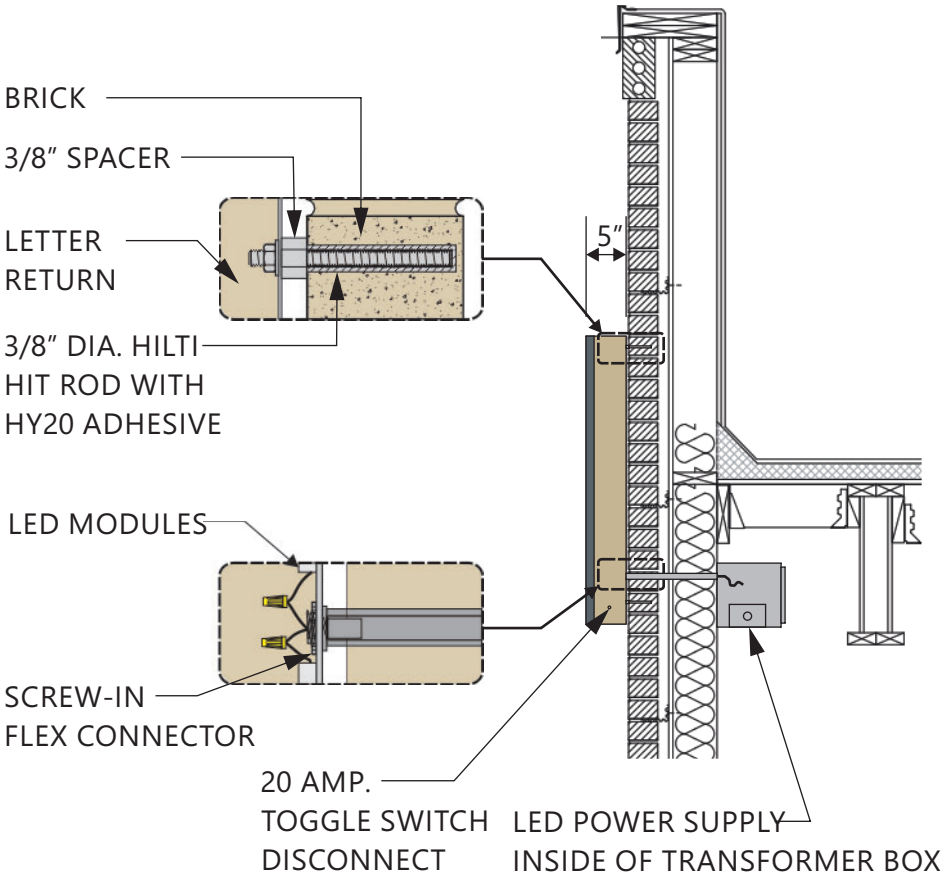

CROSS-SECTION

SCALE - 1/2" = 1'- 0"



5198 North Lake Drive  
Lake City, GA 30260  
404.361.3800  
www.claytonsigns.com

LED-ILLUMINATED  
CHANNEL LETTERS

DRAWING FILE - CFA - VIENNA, VA SIGNAGE.CDR



ALL ELECTRICAL  
SIGNS ARE  
120 VOLTS  
UNLESS  
OTHERWISE INDICATED

DRAWN BY Ben Holliday  
ACCOUNT REP. Ben Holliday  
DRAWING DATE June 16, 2016  
REVISION DATE May 15, 2020

STORE NUMBER	STORE ADDRESS
L03582	Chick-fil-A at Vienna, VA 540 Maple Avenue W Vienna, VA 22180

THIS DRAWING IS AN ORIGINAL, UNPUBLISHED DESIGN CREATED BY CLAYTON SIGNS, INC. IT IS NOT TO BE REPRODUCED, CHANGED, OR EXHIBITED TO ANYONE OUTSIDE OF YOUR COMPANY IN WHOLE OR IN PART WITHOUT WRITTEN PERMISSION FROM THE OWNER OF CLAYTON SIGNS, INC. ANY SUCH ACTIONS MAY BE SUBJECT TO LEGAL ACTION IN A COURT OF LAW.  
©2018 ALL RIGHTS RESERVED

LOCATION  
C



**CHANNEL LETTERS (RED ILLUMINATION)**

LED's  
JTSLS016R-0.4 RED LED

POWER SUPPLY  
BL-120-12-60 POWER SUPPLY

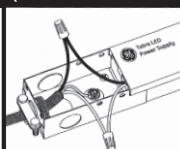

CONNECT THE AC LINE TO THE BLACK (LINE) AND WHITE (NEUTRAL) INPUT WIRES OF THE POWER SUPPLY USING 18-14 AWG TWIST ON WIRE CONNECTORS. GROUND POWER SUPPLY GREEN WIRE TO GROUNDING SCREW. REPLACE JUNCTION BOX COVER.

**WET LOCATION**

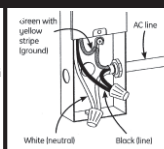

THIS SIGN IS INTENDED TO BE INSTALLED IN ACCORDANCE WITH REQUIREMENTS OF ARTICLE 600 OF THE NATIONAL ELECTRICAL CODE AND/OR APPLICABLE LOCAL CODES. THIS INCLUDES PROPER GROUNDING & BONDING OF THE SIGN.

SPECIFICATIONS

CABINET  
ALUMINUM CABINET HAS EXTRUDED ALUMINUM  
FACES  
FLEX FACES DECORATED WITH TRANSLUCENT VINYL  
FILM ON SURFACE OF ACRYLIC.  
INTERNALLY ILLUMINATED WITH WHITE LED 6500K LIGHTS.  
DISCONNECT SWITCH AS REQUIRED PER NEC.



FACES  
3M #3630-53 CARDINAL  
RED TRANSLUCENT VINYL  
CABINET  
GENESIS M SINGLE STAGE  
(G2-SERIES) RED #48247



3M PANOGRAPHIC III FLEX FACE

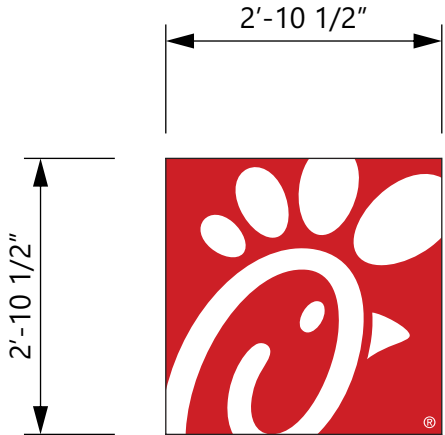

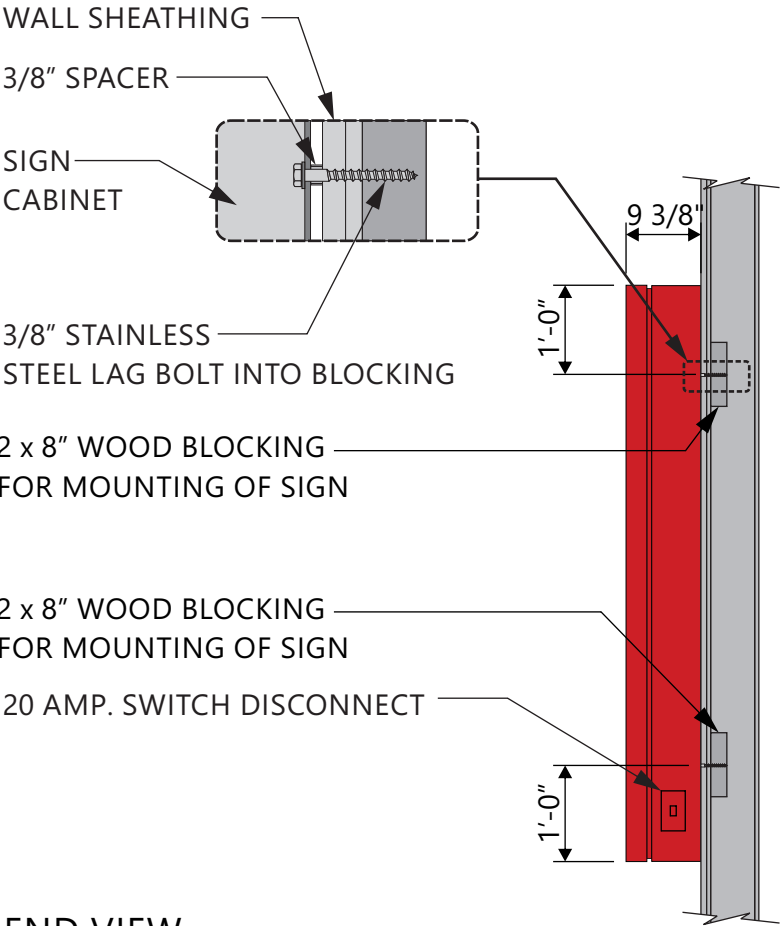

8.27 SQUARE FEET

ELEVATION  
SCALE - 1/2" = 1'- 0"



END VIEW  
SCALE - 1/2" = 1'- 0"

  
**CLAYTON Signs**  
C  US  
LISTED

**SINGLE FACED CABINET**  
  
LED's  
GEWHSPS3 - 71K - SINGLED SID  
POWER SUPPLY  
GEPST2 - 12V POWER SUPPLY

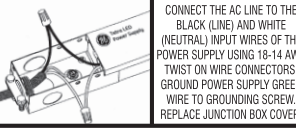
  
CONNECT THE AC LINE TO THE  
BLACK (LINE) AND WHITE  
(NEUTRAL) INPUT WIRES OF THE  
POWER SUPPLY USING 18-14 AWG  
TWIST ON WIRE CONNECTORS.  
GROUND POWER SUPPLY GREEN  
WIRE TO GROUNDING SCREW.  
REPLACE JUNCTION BOX COVER.

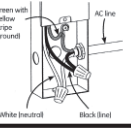
  
WET LOCATION  
green with  
yellow  
stripe  
ground  
AC line  
White (neutral)  
Black (line)

THIS SIGN IS ITENDED TO BE INSTALLED IN ACCORDANCE WITH REQUIREMENTS OF ARTICLE 600 OF THE NATIONAL ELECTRICAL CODE AND/OR APPLICABLE LOCAL CODES. THIS INCLUDES PROPER GROUNDING & BONDING OF THE SIGN.



5198 North Lake Drive  
Lake City, GA 30260  
404.361.3800  
www.claytonsigns.com

WALL SIGN

DRAWING FILE - CFA - VIENNA, VA SIGNAGE.CDR

ALL ELECTRICAL  
SIGNS ARE  
120 VOLTS  
UNLESS  
OTHERWISE INDICATED

DRAWN BY Ben Holliday  
ACCOUNT REP. Ben Holliday  
DRAWING DATE June 16, 2016  
REVISION DATE May 15, 2020

STORE NUMBER	STORE ADDRESS
L03582	Chick-fil-A at Vienna, VA 540 Maple Avenue W Vienna, VA 22180

THIS DRAWING IS AN ORIGINAL, UNPUBLISHED DESIGN CREATED BY CLAYTON SIGNS, INC. IT IS NOT TO BE REPRODUCED, CHANGED, OR EXHIBITED TO ANYONE OUTSIDE OF YOUR COMPANY IN WHOLE OR IN PART WITHOUT WRITTEN PERMISSION FROM THE OWNER OF CLAYTON SIGNS, INC.. ANY SUCH ACTIONS MAY BE SUBJECT TO LEGAL ACTION IN A COURT OF LAW.  
©2018 ALL RIGHTS RESERVED

LOCATION  
E