

**444 Maple**  
 Town of Vienna, Virginia

Owner  
 Hekman & Co., Inc.  
 505 Main Street, P.O. Box 667  
 Hackensack, NJ, 07602  
 1.201.487.1500

Architect  
 KTG  
 8609 Westwood Center Dr #600  
 Tysons, VA 22182  
 1.703.245.1090

Civil Engineer  
 Walter L. Phillips  
 207 PARK AVENUE  
 Falls Church, VA 22046  
 1.703.532.6163

SEAL

ISSUED FOR	DATE
1 50% DD	10/08/19
2 DESIGN DEVELOPMENT	11/22/19
3 50% CD	01/06/20
PROGRESS SET	03/05/20
4 PERMIT SET	05/08/20

PROJECT NO. 17041 SCALE: As Shown

DRAWN BY: BB, RJ, BH REVIEWED BY: MR

**L-4.09**  
 HARDSCAPE DETAILS

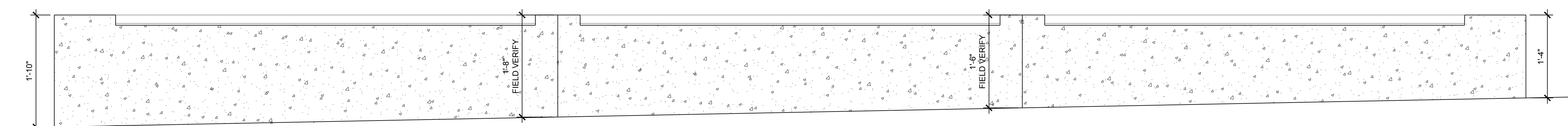

BENCH TYPE B - ELEVATION  
 NOTES:  
 1. FIELD VERIFY GRADES PRIOR TO FABRICATION

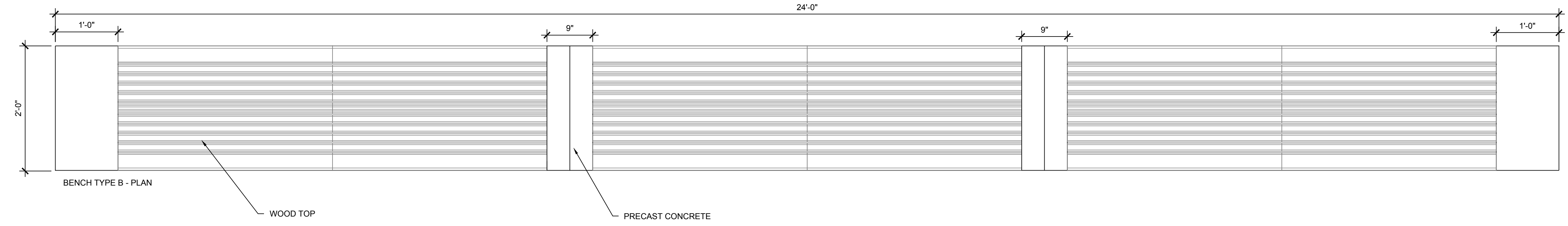

BENCH TYPE B - PLAN  
 WOOD TOP  
 PRECAST CONCRETE

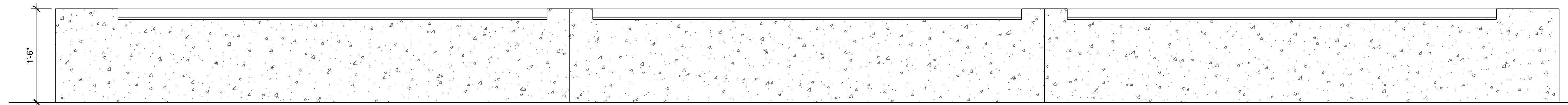

BENCH TYPE A - ELEVATION

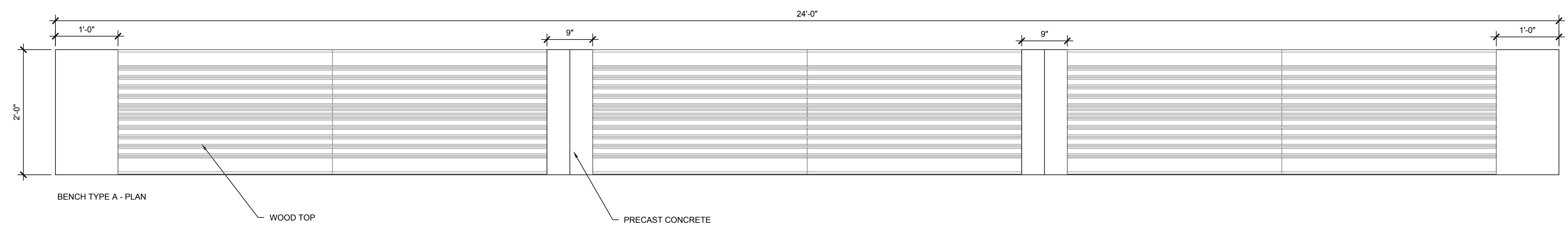

BENCH TYPE A - PLAN  
 WOOD TOP  
 PRECAST CONCRETE

**1 BENCH (B2)**  
 1"=1'-0"

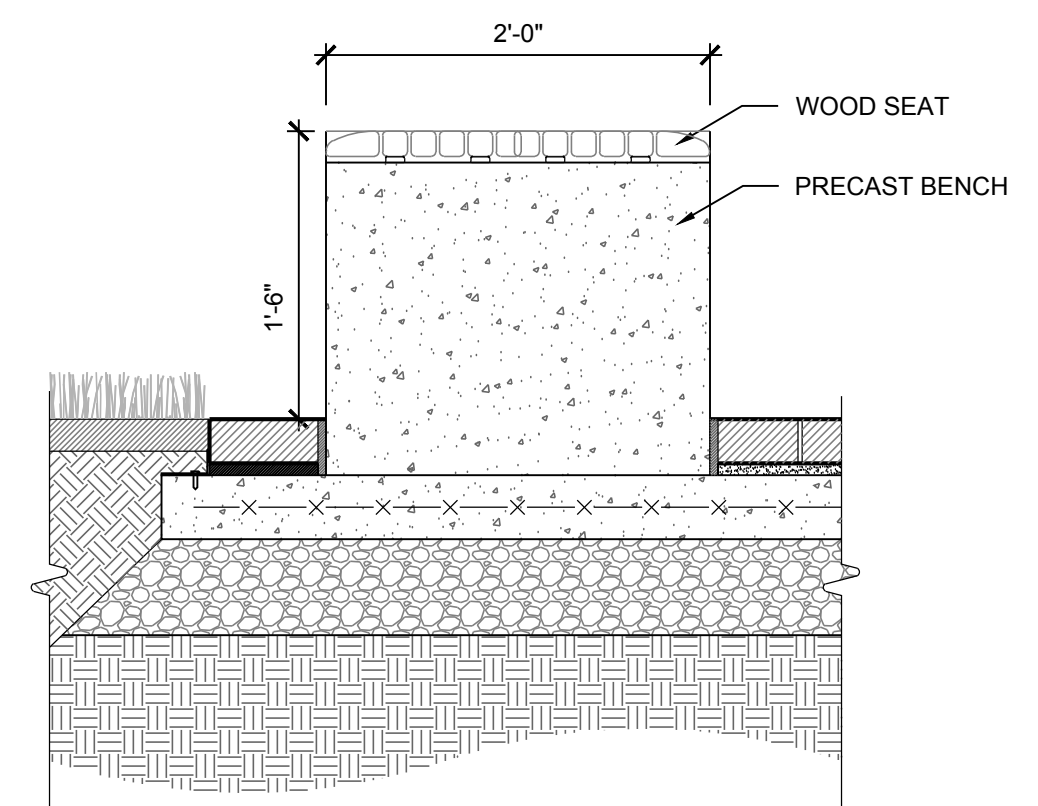

**2 BENCH - B2**  
 1"=1'-0"