

SECTION 129300 - SITE FURNISHINGS

PART 1 - GENERAL

1.1 SUMMARY

- A. Section Includes:
 - 1. Bench (B1, B2 and B3)
 - 2. Bollard
 - 3. Bike rack
 - 4. Litter and recycle receptacle
 - 5. Planters (PL1, PL2, PL3)
 - 6. Artificial Turf
 - 7. Grill
 - 8. SS Sink with SS cover
 - 9. Fire Pit
 - 10. Drinking water fountain
 - 11. Trench Drain Cover / Grate
 - 12. Area Drain Cover / Grate

1.2 ACTION SUBMITTALS

- A. Product Data: For each type of product.
- B. Samples: For each exposed product and for each color and texture specified.
- C. Samples for Initial Selection: For units with factory-applied finishes.
- D. Samples for Verification: For each type of exposed finish, not less than 6-inch-long linear components and 4-inch-square sheet components.
- E. Product Schedule: For site furnishings. Use same designations indicated on Drawings.
- F. Shop Drawings: Submit manufacturer's shop drawings, including plans and elevations, indicating overall dimensions and materials.

1.3 INFORMATIONAL SUBMITTALS

- A. Material Certificates: For site furnishings.
 - 1. Wood Preservative Treatment: Include certification by treating plant stating type of preservative solution and pressure process used, net amount of preservative retained, and compliance with applicable standards.

1.4 CLOSEOUT SUBMITTALS

- A. Maintenance Data: For site furnishings to include in maintenance manuals.

1.5 QUALITY ASSURANCE

- A. Manufacturer Qualifications: Manufacturer regularly engaged in manufacture of site furnishings since last 25 years. Provide minimum five similar reference projects with direct contact information.
- B. Product Support: Products are supported with complete engineering drawings.

1.6 MAINTENANCE MATERIAL SUBMITTALS

- A. Furnish extra materials that match products installed and that are packaged with protective covering for storage and identified with labels describing contents.
 - 1. Bench Replacement Slats: No fewer than 10 full-size units for each size indicated.
 - 2. Trash Receptacle Inner Containers: Five full-size units for each size indicated, but no fewer than two units.
 - 3. Anchors: 15 of each size.
 - 4. IPE slats – 10 of each size

PART 2 - PRODUCTS

2.1 BENCH (B1, B2 and B3)

B1

- A. Manufacturer: Victor Stanley, <https://www.victorstanley.com/product/eva/>
- B. Type: Eva with back and IPE wood slats
- C. Color: Black (submit RAL color chart for final selection)
- D. Installation Method: Mounted onto pavers (through bolt to concrete topping slab)

B2

- E. Manufacturer for wood top seats: ID Created, <https://idcreated.com/products/seating/diamante-wood-seats>
- F. Type: Diamante wood seats with no back
- G. Wood: Oil treated Jatoba
- H. Installation Method: Mounted onto precast bench, refer to contract drawings

- I. Precast concrete for bench: white color with light acid etch – submit samples showing color & finish
- J. Manufacturer: Southside Precast
B3
- K. Wood: Oil treated Jatoba or IPE
- L. Custom size and length
- M. Installation Method: Mounted into planter wall, refer to contract drawings. Submit shop drawings and signed & sealed structural drawings.

2.2 BOLLARD

- A. Manufacturer: Calpipe Bollards, <http://www.calpipebollards.com/architectural/heritage-decorative-covers/>
- B. Type: Heritage decorative covers
- C. Size: 5" dia
- D. Color: Black powder coat (submit RAL colors for final selection)
- E. Installation Method: Embedded in concrete per manufacturer's guidelines and structural engineer's drawings

2.3 BIKE RACK

- A. Manufacturer: Landscape Forms, <https://www.landscapeforms.com/en-US/product/Pages/Ride-Bike-Rack.aspx>
- B. Type: Ride
- C. Color: Black (submit RAL color chart for final selection)
- D. Installation Method: Cast in concrete

2.4 LITTER AND RECYCLE RECEPTACLE

- A. Manufacturer: Victor Stanley
- B. Type: Sage SGE-36SA with perforated panels
- C. Capacity: 36 gallons with plastic liner
- D. Color: Black (submit RAL color chart for final selection)

- E. Installation Method: Freestanding or installed in concrete/ pavers – refer to contract drawings.
- F. Contractor to submit order form as part of submittal for landscape architect to select accessories

2.5 PLANTERS (PL1, PL2)

- A. Manufacturer: ORE Planters <https://ore.design/>.
- B. Provide drainage holes at the bottom, adjustable feet
- C. Installation Method: Freestanding with Mona water reservoir system by Mona Plant Systems or approved equal. Quantity of links to be determined by manufacturer, provide shop drawings showing the same.

PL1

- A. Model: Cube
- B. Size: 1002
- C. Color: Charcoal grey

PL2

- A. Model: Mid Rectangle
- B. Size: 1005
- C. Color: Charcoal grey

PL3 (group)

- D. Model: Capsule + Cube + Column
- E. Size: 1209 + 1001 + 1008
- F. Color: Charcoal grey

2.6 ARTIFICIAL TURF

1. Manufacturer: www.xgrass.com.
2. Style: Super Lawn Xtreme with dura flow backing, fiber type omega and pile height 2 1/8"
3. Infill: Envirofill
4. Color: Blend
5. Thatch: Brown
6. Padding: 1" minimum SofPad

7. To be compliant with local weather and building codes including wind lift. Manufacturer to provide details and assembly based on project roof section.

2.7 GRILL

- A. Manufacturer: Sunstone Metal Products, www.sunstonemetalproducts.com.
- B. Product: 5 burners with lights 42", stainless steel, Infrared
- C. Item No. RUBY5BIR-Ruby 5 burner Pro-sear 42" w/IR with matching SS cart (46" Sunstone gas grill base cabinet SAC46GLPCD) for freestanding grill with adjustable legs and matching trim kit.
- D. Confirm with manufacturer size of opening for the grill in the counter at the time of ordering and field verify dimensions.

2.8 SS SINK WITH SS COVER

- A. Manufacturer: Just Manufacturing, SS Single bowl, <https://www.justsinks.com>, 847-678-5151
- B. Model: SL-ADA-2225-A-GR-M drop in single bowl, 5.5" deep bowl
- C. ADA compliant
- D. Finish: SS Polished to a hand-blended JUST finish, with highlighted bowl rim, 18-gauge, Type 316
- E. Sink Cover: Type 316 removable cover to fit SL-ADA-2225-A-GR-M sink
- F. Confirm with manufacturer size of opening for the sink in the counter at the time of ordering and field verify dimensions.

2.9 FIRE PIT

- A. Refer to contract drawings for details.
- B. Manufacturer: Ore.design, <https://ore.design/products/cylinder-fire-pit/>
- C. Model: Cylinder Fire Pit 4014 with granite top
- D. Glass enclosure/surround around the fire pit
- E. Fire pit lid
- F. Lava rocks – black lava rock
- G. Electronic pilotless ignition system

- H. Finish: Charcoal grey
- I. Metal spark arrestor on top of glass enclosure to meet code
- J. Emergency shut off to be provided per code
- K. Fire pit to comply with all local and building codes

2.10 DRINKING WATER FOUNTAIN

- A. Manufacturer: Haws
- B. Model # 3202G Barrier free
- C. Color: Silver
- D. ADA compatible drinking water fountain

2.11 TRENCH DRAIN COVER / GRATE

- A. Manufacturer: Iron Smith
- B. Model: 4" and 8" wide
- C. ADA complaint and heel-proof
- D. Finish: Aluminum
- E. Refer to MEP for all drain body specs and details.

2.12 AREA DRAIN COVER / GRATE

- A. Manufacturer: Urban Accessories
- B. Model: OPCB, 8" square
- C. Size: 8" square, to be ADA compliant
- D. Finish: Brush Aluminum
- E. Refer to MEP for all drain body specs and details.

2.13 MATERIALS

- A. Aluminum: Alloy and temper recommended by aluminum producer and finisher for type of use and finish indicated; free of surface blemishes and complying with the following:
 - 1. Rolled or Cold-Finished Bars, Rods, and Wire: ASTM B 211.

2. Extruded Bars, Rods, Wire, Profiles, and Tubes: ASTM B 221.
 3. Structural Pipe and Tube: ASTM B 429.
 4. Sheet and Plate: ASTM B 209.
 5. Castings: ASTM B 26.
- B. Steel and Iron: Free of surface blemishes and complying with the following:
1. Plates, Shapes, and Bars: ASTM A 36.
 2. Steel Pipe: Standard-weight steel pipe complying with ASTM A 53, or electric-resistance-welded pipe complying with ASTM A 135.
 3. Tubing: Cold-formed steel tubing complying with ASTM A 500.
 4. Mechanical Tubing: Cold-rolled, electric-resistance-welded carbon or alloy steel tubing complying with ASTM A 513, or steel tubing fabricated from steel complying with ASTM A 1011 and complying with dimensional tolerances in ASTM A 500; zinc coated internally and externally.
 5. Sheet: Commercial steel sheet complying with ASTM A 1011.
 6. Expanded Metal: Carbon-steel sheets, deburred after expansion, and complying with ASTM F 1267.
 7. Malleable-Iron Castings: ASTM A 47, grade as recommended by fabricator for type of use intended.
 8. Gray-Iron Castings: ASTM A 48, Class 200.
- C. Stainless Steel: Free of surface blemishes and complying with the following:
1. Sheet, Strip, Plate, and Flat Bars: ASTM A 666.
 2. Pipe: Schedule 40 steel pipe complying with ASTM A 312.
 3. Tubing: ASTM A 554.
- D. Anchors, Fasteners, Fittings, and Hardware: Stainless steel Manufacturer's standard, corrosion-resistant-coated or non-corrodible materials; commercial quality, tamperproof, vandal and theft resistant, concealed, recessed, and capped or plugged.
1. Angle Anchors: For inconspicuously bolting legs of site furnishings to below-grade substrate; one per leg.
 2. Antitheft Hold-Down Brackets: For securing site furnishings to substrate; two per unit extent as indicated on Drawings.
- E. Non-shrink, Nonmetallic Grout: Premixed, factory-packaged, non-staining, noncorrosive, nongaseous grout complying with ASTM C 1107; recommended in writing by manufacturer, for exterior applications.
- F. Erosion-Resistant Anchoring Cement: Factory-packaged, non-shrink, non-staining, hydraulic-controlled expansion cement formulation for mixing with potable water at Project site to create pourable anchoring, patching, and grouting compound; resistant to erosion from water exposure without needing protection by a sealer or waterproof coating; recommended in writing by manufacturer, for exterior applications.
- G. Galvanizing: Where indicated for steel and iron components, provide the following protective zinc coating applied to components after fabrication:

1. Zinc-Coated Tubing: External, zinc with organic overcoat, consisting of a minimum of 0.9 oz./sq. ft. of zinc after welding, a chromate conversion coating, and a clear, polymer film. Internal, same as external or consisting of 81 percent zinc pigmented coating, not less than 0.3 mil thick.
2. Hot-Dip Galvanizing: According to ASTM A 123, ASTM A 153, or ASTM A 924.

2.14 WOOD-PRESERVATIVE-TREATED MATERIALS

- A. Preservative Treatment: Pressure-treat wood according to AWP A U1 and the following:
 1. Use preservative chemicals acceptable to authorities having jurisdiction and containing no arsenic or chromium. Use chemical formulations that do not bleed through or otherwise adversely affect finishes. Do not use colorants to distinguish treated materials from untreated materials.
 2. Kiln-dry lumber and plywood after treatment to a maximum moisture content, respectively, of 19 and 15 percent. Do not use materials that are warped or do not comply with requirements for untreated materials.

2.15 FABRICATION

- A. Metal Components: Form to required shapes and sizes with true, consistent curves, lines, and angles. Separate metals from dissimilar materials to prevent electrolytic action.
- B. Welded Connections: Weld connections continuously. Weld solid members with full-length, full-penetration welds and hollow members with full-circumference welds. At exposed connections, finish surfaces smooth and blended, so no roughness or unevenness shows after finishing and welded surface matches contours of adjoining surfaces.
- C. Pipes and Tubes: Form simple and compound curves by bending members in jigs to produce uniform curvature for each repetitive configuration required; maintain cylindrical cross section of member throughout entire bend without buckling, twisting, cracking, or otherwise deforming exposed surfaces of handrail and railing components.
- D. Preservative-Treated Wood Components: Complete fabrication of treated items before treatment if possible. If cut after treatment, apply field treatment complying with AWP A M4 to cut surfaces.
- E. Exposed Surfaces: Polished, sanded, or otherwise finished; all surfaces smooth, free of burrs, barbs, splinters, and sharpness; all edges and ends rolled, rounded, or capped.
- F. Factory Assembly: Assemble components in the factory to greatest extent possible to minimize field assembly. Clearly mark units for assembly in the field.

2.16 GENERAL FINISH REQUIREMENTS

- A. Appearance of Finished Work: Noticeable variations in same piece are not acceptable. Variations in appearance of adjoining components are acceptable if they are within the range of approved Samples and are assembled or installed to minimize contrast.

2.17 ALUMINUM FINISHES

- A. Baked-Enamel, Powder-Coat Finish: Manufacturer's standard, baked, polyester, powder-coat finish complying with finish manufacturer's written instructions for surface preparation, including pretreatment, application, baking, and minimum dry film thickness.

2.18 STEEL AND GALVANIZED-STEEL FINISHES

- A. Baked-Enamel, Powder-Coat Finish: Manufacturer's standard, baked, polyester, powder-coat finish complying with finish manufacturer's written instructions for surface preparation, including pretreatment, application, baking, and minimum dry film thickness.
- B. PVC Finish: Manufacturer's standard, UV-light stabilized, mold-resistant, slip-resistant, matte-textured, dipped or sprayed-on, PVC-plastisol finish, with flame retardant added; complying with coating manufacturer's written instructions for pretreatment, application, and minimum dry film thickness.

2.19 IRON FINISHES

- A. Baked-Enamel, Powder-Coat Finish: Manufacturer's standard, baked, polyester, powder-coat finish complying with finish manufacturer's written instructions for surface preparation, including pretreatment, application, baking, and minimum dry film thickness.

2.20 STAINLESS-STEEL FINISHES

- A. Surface Preparation: Remove tool and die marks and stretch lines, or blend into finish.
- B. Polished Finishes: Grind and polish surfaces to produce uniform finish, free of cross scratches.
 - 1. Run directional finishes with long dimension of each piece.
 - 2. Dull Satin Finish: No. 6

PART 3 - EXECUTION

3.1 EXAMINATION

- A. Examine areas and conditions, with Installer present, for compliance with requirements for correct and level finished grade, mounting surfaces, installation tolerances, and other conditions affecting performance of the Work.
- B. Notify architect of conditions that would adversely affect installation or subsequent use.
- C. Proceed with installation only after unsatisfactory conditions have been corrected.

3.2 INSTALLATION, GENERAL

- A. Comply with manufacturer's written installation instructions unless more stringent requirements are indicated. Complete field assembly of site furnishings where required.
- B. Unless otherwise indicated, install site furnishings after landscaping and paving have been completed.
- C. Install site furnishings level, plumb, true, and securely anchored and positioned at locations indicated on Drawings.
- D. Finish and repair any damages caused to finish or product in accordance with manufacturer's instructions and as approved by Landscape Architect.
- E. Component Damage: Remove and replace damaged components that cannot be successfully repaired as determined by Landscape Architect.
- F. Clean products promptly after installation in accordance with manufacturer's instructions. Do not use harsh cleaning materials or methods that could damage finish.
- G. Post Setting: Set cast-in support posts in concrete footing with smooth top, shaped to shed water. Protect portion of posts above footing from concrete splatter. Verify that posts are set plumb or at correct angle and are aligned and at correct height and spacing. Hold posts in position during placement and finishing operations until concrete is sufficiently cured.
- H. Posts Set into Voids in Concrete: Form or core-drill holes for installing posts in concrete to depth recommended in writing by manufacturer of site furnishings and 3/4 inch larger than OD of post. Clean holes of loose material, insert posts, and fill annular space between post and concrete with non-shrink, nonmetallic grout, mixed and placed to comply with anchoring material manufacturer's written instructions, with top smoothed and shaped to shed water.
- I. Pipe Sleeves: Use steel pipe sleeves preset and anchored into concrete for installing posts. After posts have been inserted into sleeves, fill annular space between post and sleeve with non-shrink, nonmetallic grout, mixed and placed to comply with anchoring material manufacturer's written instructions, with top smoothed and shaped to shed water.

END OF SECTION



SHAN

SHAN is a state-of-the-art cassette awning. When it comes to your house or establishment, you want a cassette awning that works perfectly and shades without compromising the aesthetic line. SHAN meets all these requirements and fully integrates with the architecture.

Because of its marked shape and design, the SHAN is wall mount only and always motorized. The D.T.S. system (Dynamic Tilting System) allows the tilting of the support when the awning is retracting, maintaining a perfect closure of the cassette. The special gasket along the length of the front bar makes the awning watertight and ensures silent closure.

The compact box dimension is 10.16" in height and 7.28" deep. A single section is up to 23' (276") width and can reach a 13'6" (162") projection.

The SHAN uses the patented feature arm URBAN, the essence of the most advanced technology and fine Italian design. It features the innovative Dynamic Arm Torsion System, which helps to protect the traction mechanism and to prevent fabric tears.

Pitch adjustment is available from 0° to 40°. The micrometric regulation of pitch allows for easy and precise adjustment. The Shan is also motorized with a Somfy brand or Nice brand torque sensing motor with the limits preset at the factory.

Standard Frame colors available for the Shan are White Sable, Anthracite, & Corten—all finishes are matte.

A complete line of awning fabrics are available, featuring our Para Tempotest line of 100% acrylic awning material.

The Shan is a design patented system.

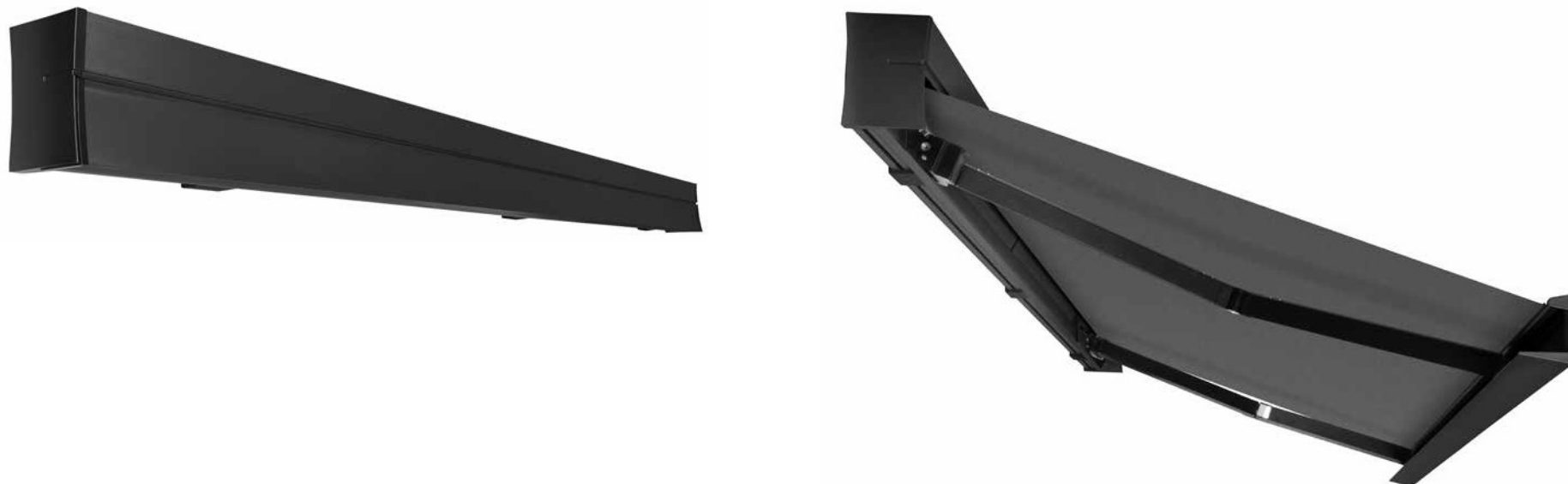

SUMMARY

Retractable arm awning with cassette
 Pitch ranges between 0° and 40°
 Micrometric regulation of pitch
 URBAN Arm with DAT System
 AcquaStop System
 Stainless steel screws and pins
 Wall mount only
 Motorized only (Somfy or Nice available)
 2010 Red Dot Design Award winner
 Standard matte frame colors—
 White Sable, Anthracite & Corten

PROJECTION & PITCH*

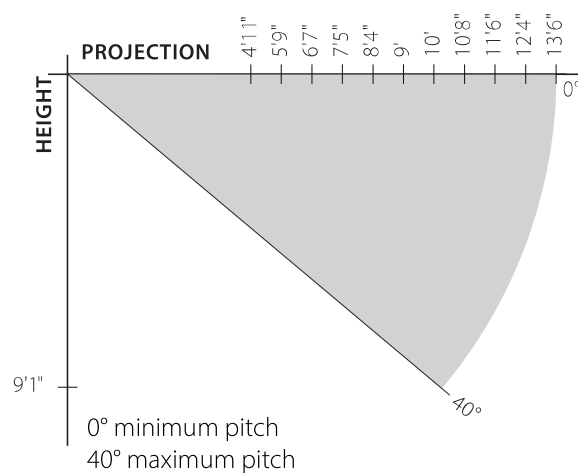

WIDTH RANGE

Projection*	Min. width	Max. width
8'4"	118"	276"
10'	138"	276"
11'6"	157"	276"
13'6"	177"	276"

*Maximum projection indicated is intended with arms at 0° pitch, perpendicular to the mounted wall. Increasing the pitch will decrease the projection when measured in a straight/perpendicular line from the mounted wall.

Shan profile dimensions
with folded arms
wall installation

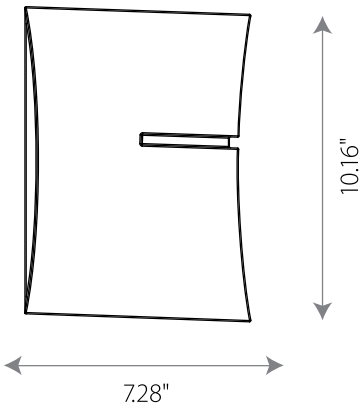

Shan wall bracket
dimensions

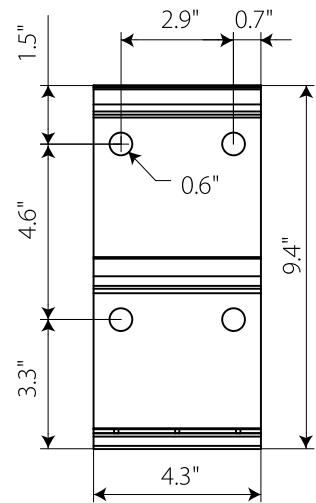

Shan wall bracket
installed side view



**SHAN uses the URBAN arm
featuring the DAT SYSTEM.**

The URBAN arm is the essence of advanced technology and fine Italian design. No compromise on performances and details. An unprecedented retractable arm of unique design with raw materials of highest quality and the advanced technology of the DAT System come together to make the Urban arm a masterpiece in the world of shading.

DATSYSTEM: The distance between fabric and arm increases when deployed to protect the fabric.



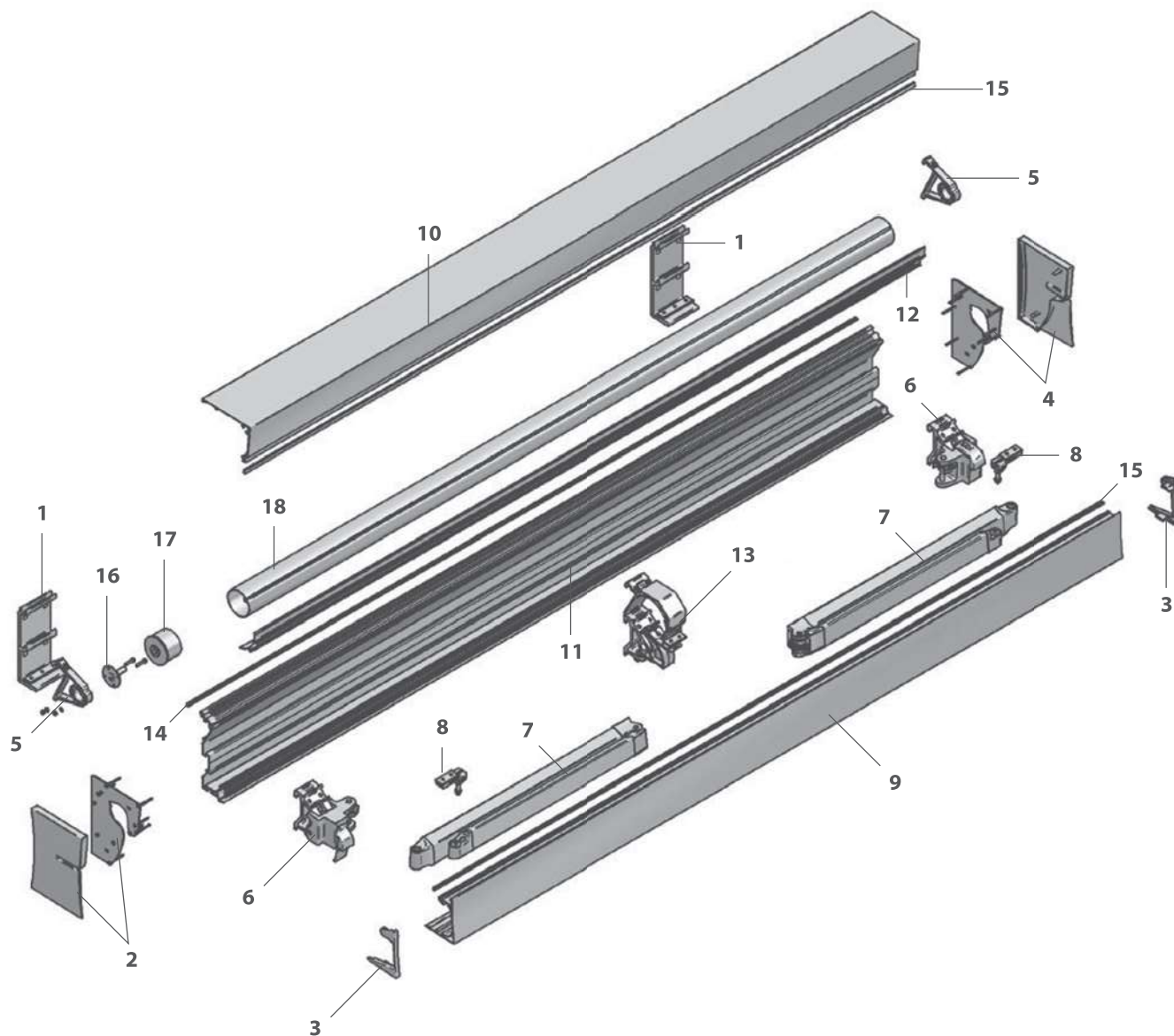

- 1** - Wall brackets
- 2** - Left cassette end cap set
- 3** - Front bar end caps
- 4** - Right cassette end cap set
- 5** - Roller tube supports
- 6** - Arm supports
- 7** - Arms
- 8** - Front bar connectors
- 9** - Front bar
- 10** - Cover (top)
- 11** - Cassette (bottom)
- 12** - Saddle
- 13** - Central support with conveyor
- 14** - Balloon gasket
- 15** - Brush
- 16** - Plate with pin
- 17** - End cap with hole
- 18** - 78mm roller tube



Create a timeless moment.®

BACKED WOOD SLATS METAL - BLACK



EVA

Equal parts style, comfort and sustainability, our new Eva bench is the latest engineering achievement in the Reverie Collection. Like other products in the line, Eva embodies attention to high quality design, craftsmanship and relaxation. Its slim profile and integral armrests make for sleek design. In addition, its exceptionally high recycled steel content is sourced from domestic electric furnace mills. In fact, approximately 98% of the raw material of our A36 steel bar is post-consumer or post-industrial, making green even greener. It's just one more way Victor Stanley helps you create timeless moments.

2, 4, 6 or 8 ft (.61, 1.2, 1.8 or 2.4 m) length. 8 ft (2.4 m) length includes center arm/leg with wood slats and a center leg with steel slats.

*Covered by one or more of the following: US Patent D710,625 S; D710,139 S.

STANDARD

All fabricated metal components are steel shotblasted, etched, phosphatized, preheated and electrostatically powder-coated with TGIC polyester powder coatings.

OPTIONS

RETURN TO STANDARD VIEW

MATERIAL

Recycled Solid Steel Bar

Wood

LENGTH

2 ft (.61 m)

4 ft (1.2 m)

6 ft (1.8 m)

8 ft (2.4 m)

Horizontal steel slat seating for 4, 6, or 8 ft (1.2, 1.8 or 2.4 m) length.
Wood slat seating. Surface mount. In-ground mount. Intermediate armrests (bolt-on).

COLORS

Standard



Optional RAL



SLATS

Wood



COORDINATING PRODUCTS

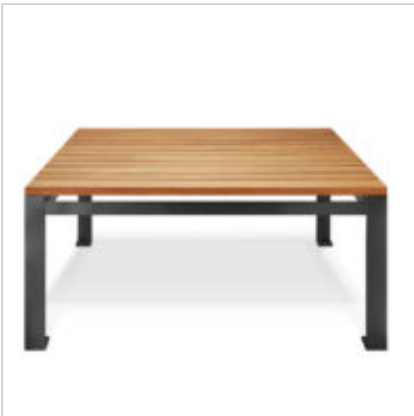

CAMILLE COFFEE TABLE

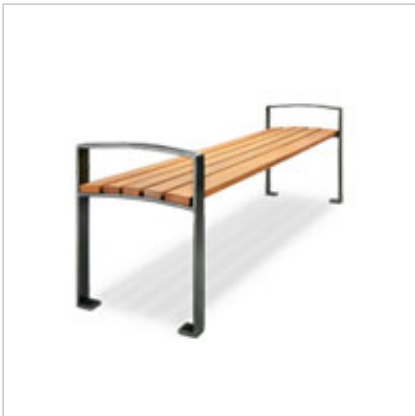

EVA BACKLESS [compare](#)



SDC-36 [compare](#)

compare

Copyright 2013 - 2021 Victor Stanley, Inc.® All rights reserved.

1.800.368.2573 (USA + Canada) TEL 301.855.8300

Most Victor Stanley benches are ADA compliant. Member of the ASLA. Member of the USGBC.



Site Map ▼

Collections	Products	About Us	Contact Us	Design Resources
Anthro Sites™	Victor Stanley Relay	General Information	Request Form	Product Library
City Sites™	Litter Receptacles	Environmental	Find Your Representative	Installations
Classic	Recycling Stations	Commitment	Support	My Account
Concourse	Benches	Manufacturing Capability	Directions	
Corridor	Planters		E-News Sign-Up	
Cycle Sentry™	Bike Racks & Bollards		Follow Us,	
Dynasty	Tables		Facebook Twitter	
Economy	Seats		LinkedIn	
Fiberglass	Ash Urns			
Framers Modern™	Tree Guards			
Geometric				
GreenSites				
Homestead				
Ironsites®				
Parsons				
Perenne				
Production				
ProTone™				
Reverie				
Steelsites™				
Steelsites™ RB				
Stella Of Sunne™				
Street Sentry™				
Streetsites™				

OIL TREATED JATOBA WOOD NO BACK

DIAMANTE

MICHELE SLAVIERO

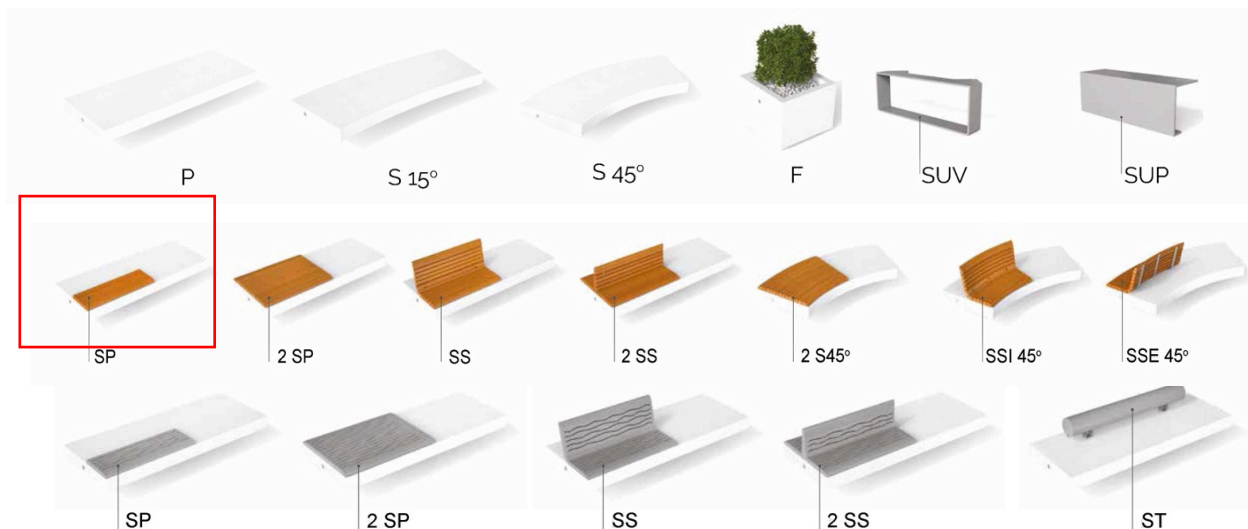

The Diamante, designed by Michele Slaviero, is a modular collection of benches, accessories and a planter. The Diamante is a component piece made of High Performance Concrete in a straight or curved section, with "empty" or "fully enclosed" supports and featuring seating accessories in wood, powder coated steel or tubular backrest in your choice of powder coated steel or electropolished stainless steel.



MATERIALS & FINISHES

- High Performance Concrete (HPC)
 - Granite
 - White Marble
 - All sides VELLUTO (standard)
 - Polished top with VELLUTO sides (upon request)
 - All polished (upon request)
- Hardwood seat accessories
- Powder Coated Steel seat accessories and supports
- Electropolished Stainless Steel (SUV supports and tubular backrest only)

TREATMENTS

- Anti-Deterioration (standard)
- Anti-Graffiti for HPC & Powder Coated Steel (upon request)
- Zinc Rich TRIPLEX primer for Powder Coated Steel (upon request)

FOOTING

- Surface mount



id created, Inc. is a US based company with exclusive rights to distribute Metalco srl products in the US and Canada.

877.690.7755
info@idcreated.com
idcreated.com

DIAMANTE

MICHELE SLAVIERO

HPC Plane

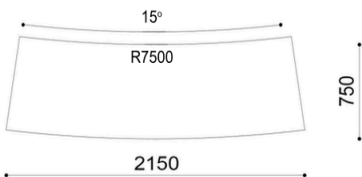
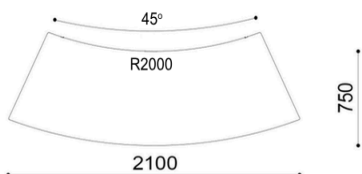
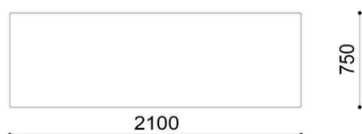

Planter

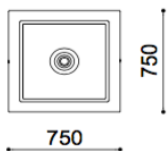

All measurements
in millimeters.

Wood Accessories

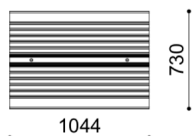
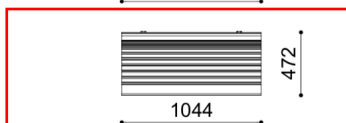
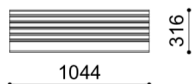
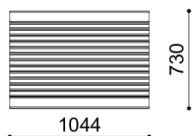
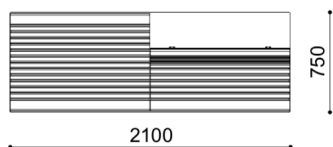
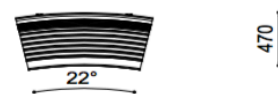
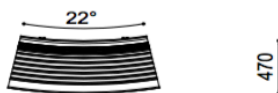
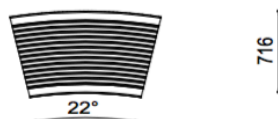
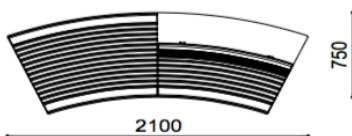

Steel Accessories

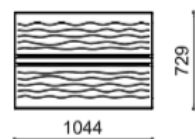
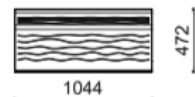
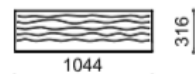
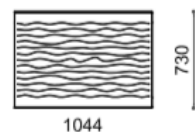
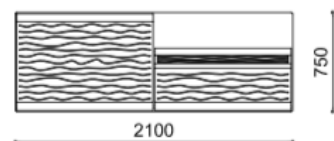
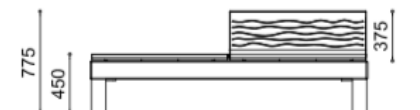

Tubular Steel Backrest

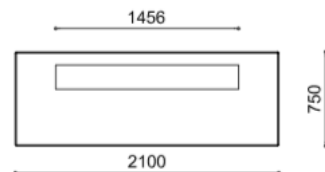

id created, Inc. is a US based company with
exclusive rights to distribute Metalco srl products in
the US and Canada.

877.690.7755
info@idcreated.com
idcreated.com

METRO40

Product Data Sheet



Ride™ Bike Rack

- Capacity: 2 bikes
- Surface mount or embedded to concrete surface.
- Requires only two bolts to mount, with extra surface mount anchor hole provided.
- 4 stainless steel leveling glides within the base are provided for fine adjustment from top side of base.
- Cover plate over bike rack base provides seamless appearance.

	STYLE	DEPTH	WIDTH	HEIGHT	PRODUCT WEIGHT
	bike rack	3.3"	28"	26"	50 lb

BLACK POWDER COAT

Hi-Glo™ Pedestrian Light and Lo-Glo™ Path Light

- Please refer to product data sheets for technical information and specifications.

Connect™ Shelter

- Please refer to the Metro40 Workbook.

To Specify

Visit landscapeforms.com.

Designed by BMW Group Designworks

Rest Bench is protected by
U.S. Patent No. D600,460; D601,361; D601,820
Connect Rail is protected by U.S. Patent No. D644,446; D602,271
Collect is protected by U.S. Patent No. D607,171; D610,322, D608,968
Stop is protected by U.S. Patent No. D608,913
Ride is protected by U.S. Patent No. D613,646

Visit landscapeforms.com for more information. Specifications are subject to change without notice.
Landscape Forms supports the Landscape Architecture Foundation at the Second Century level.
©2017 Landscape Forms, Inc. Printed in U.S.A.

OPTIONAL ACCESSORIES

MIMIK 20 BOLLARD



02401
Bollard h 40"

Iron gray

MIMIK 20 LINE BOLLARD



02404
Line Bollard h 40"

Iron gray

TYPE EXB1 (QTY-4)
Custom Height - Coordinate with Planter Wall
for 36" Overall Height

Type IV Optic
20% Output

MIMIK 20

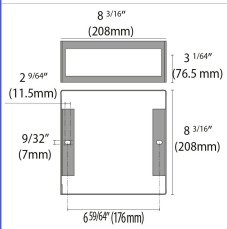

310445
Customising ring / Facade Accessory

Iron gray

TYPE EXW1 (QTY-2)

Type IV Optic
50% Output

Heritage Decorative Covers

[Home](#) / [Products](#) / [Architectural](#) / Heritage Decorative Covers

Fixed Bollard

Fixed - Base Plate Bollards

External Padlocking Removable
BollardsInternal Locking Removable
Bollards

Manual Lift Retractable Bollards

Assisted Lift Retractable Bollards

Automatic Retractable Bollards

Shallow Mount Bollards

Lighted Bollards

Heritage Decorative Covers

CAD details

Heritage Decorative Covers

Calpipe Security Bollard's Heritage line of classic shapes and profiles provide designers and planners with a broad range of choices that can be used to re-imagine existing projects or to provide a traditional look for a project still in the design and permitting stage. From purely decorative bolt-down versions to sophisticated additions to our highest security rated bollards, our Heritage line offers flexibility and aesthetics to safety and security projects where style and profile options have been limited.

Made in America by experts with 140 years of experience, these Heritage bollards are versatile enough to be used as purely decorative fixtures or combined with our full line of Anti-Terrorist crash tested bollards. Imagine having the flexibility to use the same profiles and classic features across a campus or large facility with different levels of impact ratings. The Heritage line gives owners and architects a Made In America choice for these decorative fixed or removable bollards, lighted bollards, and impact tested fixed and removable bollards.

No other fully domestic product line offers this capability - and we are proud to offer it as part of our product range.



5" DIA
BLACK POWDER COAT

MID-RECTANGLE

CHARCOAL GREY



Quick Ship
ships within
5 weeks

- 1 [Size Options](#)
- 2 [Design Options](#)
- 3 [Finish Options](#)
- 4 [Add to quote](#)

1

- 1104: L 25' W 18' H 18' | 55 lbs steel • 23 lbs aluminum
- 1105: L 42' W 18' H 18' | 80 lbs steel • 33 lbs aluminum
- 1106: L 60' W 18' H 18' | 107 lbs steel • 45 lbs aluminum

All products can be custom built to suit specific needs. Please contact our estimating department to discuss your customization needs.

- Product typically ships within 2-3 weeks. Material option availability may vary. Exclusions may apply.

Specifications

CAPSULE

CHARCOAL GREY



1 [Size Options](#)

2 [Design Options](#)

3 [Finish Options](#)

4 [Add to quote](#)

1

1209: SMALL – DIA 20" H 15.5" | 26 lbs steel • 11 lbs aluminum
1210: LARGE – DIA 28" H 21.5" | 53 lbs steel • 22 lbs aluminum

All products can be custom built to suit specific needs. Please contact our estimating department to discuss your customization needs.

Specifications

COLUMN

CHARCOAL GREY



Quick Ship
ships within
5 weeks



1 Size Options

2 Design Options

3 Finish Options

4 Add to quote**1**

1008: Small – L 18" W 18" H 24" | 54 lbs steel • 23 lbs aluminum
1009: Medium – L 18" W 18" H 36" | 74 lbs steel • 31 lbs aluminum
1010: Large – L 18" W 18" H 48" | 94 lbs steel • 38 lbs aluminum

All products can be custom built to suit specific needs. Please contact our estimating department to discuss your customization needs.

- Product typically ships within 2-3 weeks. Material option availability may vary. Exclusions may apply.

Specifications

CUBE

CHARCOAL GREY



Quick Ship
ships within
5 weeks

1 Size Options

2 Design Options

3 Finish Options

4 Add to quote

1

- 1000: Small – L 17" W 17" H 18" | 40 lbs steel • 17lbs aluminum
- 1001: Medium – L 21" W 21" H 22" | 60 lbs steel • 25lbs aluminum
- 1002: Large – L 27" W 27" H 28" | 95 lbs steel • 43lbs aluminum

All products can be custom built to suit specific needs. Please contact our estimating department to discuss your customization needs.

- Product typically ships within 2-3 weeks. Material option availability may vary. Exclusions may apply.

Specifications

CUBE

CHARCOAL GREY



Quick Ship
ships within
5 weeks

1 Size Options

2 Design Options

3 Finish Options

4 Add to quote

1

1000: Small – L 17" W 17" H 18" | 40 lbs steel • 17lbs aluminum
1001: Medium – L 21" W 21" H 22" | 60 lbs steel • 25lbs aluminum
1002: Large – L 27" W 27" H 28" | 95 lbs steel • 43lbs aluminum

All products can be custom built to suit specific needs. Please contact our estimating department to discuss your customization needs.

- Product typically ships within 2-3 weeks. Material option availability may vary. Exclusions may apply.

Specifications